

# OREGON CORNER RESTORATION FORM

Section 20 Township 3N Range 28E  
 County Umatilla Date: 00-00-02

Corner Designation: 3N28R5

|   |                       |
|---|-----------------------|
| x | Condition Report Only |
|   | Not Found             |
|   | Remonumented          |
|   | Unrecorded            |
| x | Surveyed In           |
|   | Referenced Out        |

Previous Renewals / Surveys, etc.

Oregon Corner Restoration Form by David Haddock dated 1-31-2000.

Monument and Accessories Found: ( condition and source )

Found the monument as described below in good condition.

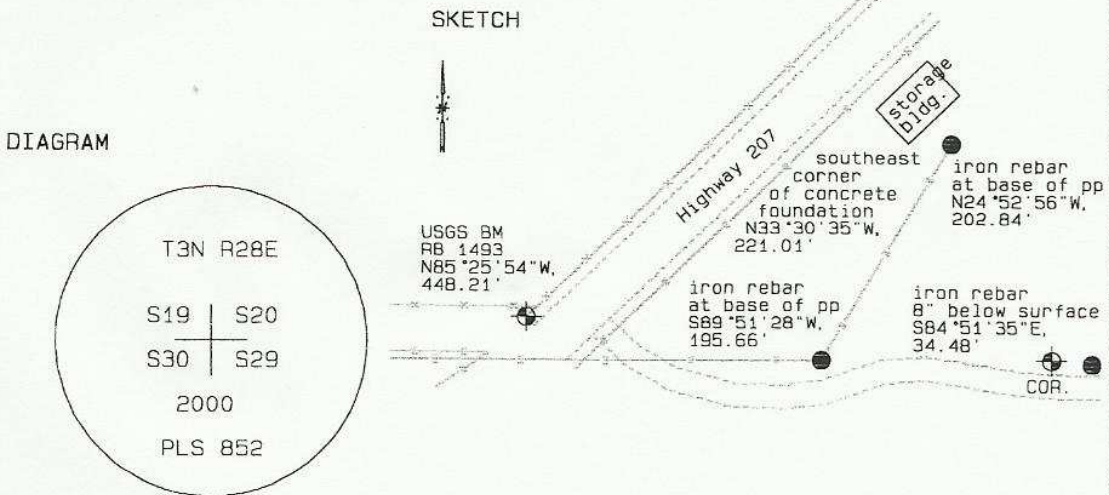

MONUMENT (S) AND ACCESSORIES SET (Procedures and Description)

None.

REFERENCES SET:

None.

Made GPS tie to TRI Station Stanfield East Base.  
 Latitude 45°43'08.50721"N  
 Longitude 119°21'08.56873"W  
 NAD 83(1991)

Oregon State Plane Coord. - North Zone  
 Northing 750330.73  
 Easting 8495206.71  
 Ortho Height 709.64  
 Ellipsoidal Height 640.00

Location and Comments

Compass Declination  
 20°E

Surveyors Seal

From the junctions of Highways 207 and 320, go north 0.6 mile. Go east on a field road approximately 300'. The corner is on the north side of the road with a steel fence post and marker sign.

REGISTERED  
 PROFESSIONAL  
 LAND SURVEYOR

RECEIVED BY:

Firm / Agency

David L. Haddock

Date: 7-02  
 Rec'd By: RE  
 No. 02-185-9

Haddock Surveying  
 P. O. Box 1574  
 Pendleton, OR 97801  
 (541) 276-2174

OREGON  
 JULY 12, 1968  
 DAVID L. HADDOCK  
 852

RENEWS 6-30-03