

OREGON CORNER RESTORATION FORM

Section 19 Township 3N Range 28E
 County Umatilla Date: January 31, 2000

Corner Designation: 3N28P5

Quarter corner to sections 19 and 20, T3N, R28E W.M.

Condition Report Only
 Not found
 Remonumented
 Unrecorded
 Surveyed in
 Referenced out

Previous Renewals / Surveys, etc.

Corner originally set by N. Gates under contract No. 84 Dated January 31, 1860.

His record reads: Set post for 1/4 section corner.

John Kimbrell records setting a monument at this corner in the survey recorded in the Record of Private surveys Book 1, Page 530 but does not say what it was.

G. M. Newbill records a rock at this location in 1954 under survey Q-506-A.

Monument and Accessories found: (condition and source)

None.

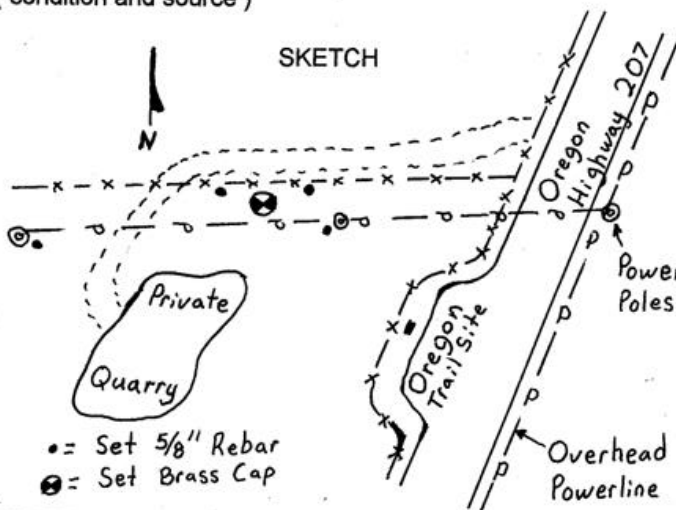
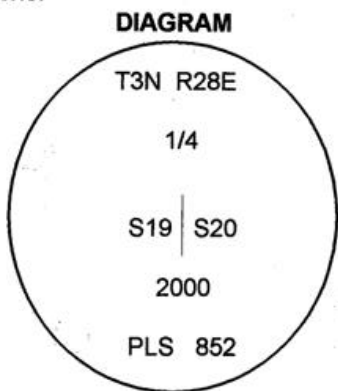

MONUMENT (S) AND ACCESSORIES SET (Procedures and Description)

I set a 1 1/4" x 30" Galvanized Iron Pipe with a 2 1/2" brass cap stamped as shown in the diagram above about 4 feet south of an existing east - west fence.

For references I set four 5/8" x 24" iron rebars with 1.25" red plastic caps stamped ORLS 852 and WALS 13922 as described below:

- an iron rebar bears S87°41'13"W, 138.03 feet at the base of a power pole;
- an iron rebar bears N83°31'22"W, 49.47 feet under the existing fence;
- an iron rebar bears N83°17'08"E, 34.42 feet under the existing fence;
- an iron rebar bears S83°46'18"E, 107.33 feet at the base of a power pole;

These references were set and tied used a LIECA system 300 RTK GPS

Location and comments

Compass Declination

Surveyors Seal

RECEIVED BY:
Umatilla County Surveyor
 Date: 3-2000
 Rec'd By: KK
 No. 00-33-B

Firm / Agency
 Haddock Surveying
 Address
 P.O. Box 1574
 Pendleton, Or. 97801
 Party Chief
 Stephen K, Haddock

REGISTERED
 PROFESSIONAL
 LAND SURVEYOR

David L. Haddock

OREGON
 JULY 12, 1968
 DAVID L. HADDOCK
 852

Renews 6/30/01