

OREGON CORNER RESTORATION FORM

SECTION 36 TOWNSHIP 3N RANGE 27E

X-25

COUNTY: UMATILLA DATE 5/1990

CORNER DESIGNATION

East Quarter Corner

CONDITION REPORT ONLY
 NOT FOUND
 RENEWED
 UNRECORDED
 SURVEYED IN
 REFERENCED OUT

PREVIOUS RENEWALS/SURVEYS, ETC.

Originally surveyed in Dec 1860. In May 1940 Otis Gould did a Dependent Resurvey in which he set a Wittnes Corner 0.35 links East.

MONUMENTS & ACCESSORIES FOUND: Condition and Source

No evidence found

MONUMENT DETAIL

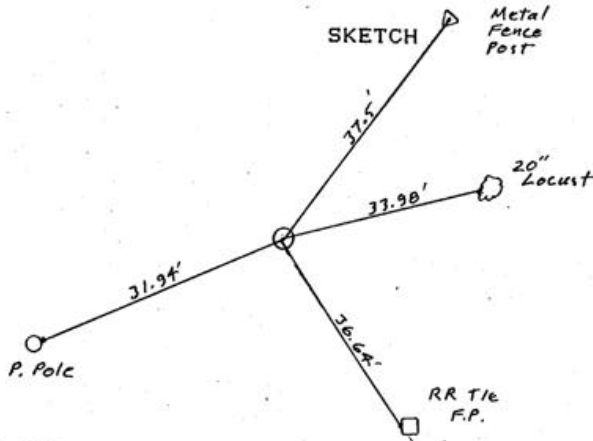

MONUMENT SET (PROCEDURES AND DESCRIPTION)

By retracing Goulds 1940 Survey (I found 4 G.L.O. corners of section 36 which Gould set) I set a 1"ID x 30" gal. Iron pipe with a 2 3/8" brass cap stamped as above, 0.3 foot below the surface of a graveled road. See Co. Survey # 90-53-A

NEW ACCESSORIES

from which
A steel fence post bears N 36° E 37.5 feet
An alum. tag in a 20" locust tree bears N 76° 36' E 33.98 ft.
An alum. tag in a RR tie fence post bears S 34° 50' E 36.64 ft
An alum. tag in a power pole bears S68° 21' W 31.94 ft.

LOCATION & COMMENTS

From the intersection Echo Hwy. and Butter Cr. Hwy. go southwest-erly 1 1/2 mile to a gravel road. Go north on gravel road 1/2 mile to corner

RECEIVED BY

Umatilla County Surveyor

Date 7-90

Rec'd by KA

90-53-1

COMPASS DEC. 18.5
FIRM EDWARDS SURVEYING
P.O. BOX 763, HERMISTON,
OREGON, 97838
PARTY CHIEF D. EDWARDS
NOTES
WITNESS J. COPPOCK

SURVEYOR'S SEAL

REGISTERED PROFESSIONAL LAND SURVEYOR

G. Dennis Edwards

OREGON
JULY 16, 1971
G. DENNIS EDWARDS
951