

Index File No. W-03 CORNER RECORD (SEARCH) (Ref. FSM 7151.4) Tract or Survey No. \_\_\_\_\_ Cor. No. \_\_\_\_\_  
 T L N R. 36 E R.D. WALLA WALLA County UMATILLA  
 Merid. W m N.F. UMATILLA State OREGON

CORNER DIAGRAM

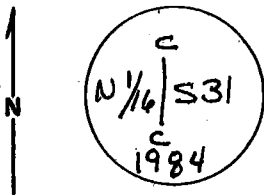

DESCRIBE CORNER MONUMENT FOUND

3 1/4" BLM BRASS CAP  
 RISING 18" IN MOUND OF STONE

DESCRIBE BEARING TREES OR OTHER OFFICIAL ACCESSORIES FOUND

8" P. PINE BEARS N 53 1/4° W, 106 LKS DIST, 70.0 FT.,  
 MARKED C N 1/4 S 31 BT

27" P. PINE BEARS S 71 3/4° E, 75 LKS DIST, 49.5 FT.,  
 BLAZED & SCRIBED C N 1/4 S 31 BT

PHOTO IDENTIFICATION DATA

Photo No. \_\_\_\_\_  
 Filed At. \_\_\_\_\_  
 Object Ident. \_\_\_\_\_  
 Ident. By \_\_\_\_\_  
 Signature \_\_\_\_\_

DESCRIBE CORNER LOCATION RELATIVE TO NEAR-BY FEATURES, ALSO HOW TO REACH CORNER

NEAR NORTH WEST CORNER LARGE FLAT RIDGE TOP  
 ROAD 3033, 0.7 MILES PAST FENCE & LINE  
 BETWEEN S 36 & S 31 THEN LEFT 'NORTH' ACROSS  
 MEADOW TO N.W. CORNER & CAP

PLANE COORDINATE POSITION DATA

State \_\_\_\_\_ Zone \_\_\_\_\_  
 X \_\_\_\_\_  
 Y \_\_\_\_\_  
 Estab. By \_\_\_\_\_  
 Agency \_\_\_\_\_

Signature A. Scott

Title LS 1844

Division \_\_\_\_\_

Headquarters \_\_\_\_\_

Date \_\_\_\_\_

6/15/85

CORNER RECORD (PERPETUATION)

MONUMENT: DESCRIBE NEW MONUMENT SET, OR WORK DONE TO PRESERVE EXISTING MONUMENT

NONE

ACCESSORIES : DESCRIBE NEW BT'S WITNESS OBJECTS ETC. ESTABLISHED, OR WORK DONE TO PRESERVE EXISTING EVIDENCE

SET STEEL FNC POST 4<sup>0</sup> FT EAST  
ATTACHED SIGNS 54-4 TO POST & BT'S  
PAINTED RED BAND AROUND BT'S

Work Done By D SCOTT Title L.S. Date 6/5/85 State Registration No. LS 1844  
Certified Cor. Record Prepared ? Yes No  Filed At: \_\_\_\_\_ Date \_\_\_\_\_

REMARKS

Index File No. W-03 T. IN R. 36E W.M. \_\_\_\_\_ Tract or Surv. No. N 1/4 Cor. 531