

OREGON CORNER RESTORATION FORM

COUNTY: Umatilla DATE: 05/25/05

CORNER DESIGNATION: IN33, L-09, The West Quarter Corner of Section 16.

PREVIOUS RENEWALS/SURVEYS ETC.: Corner most recently established by Currin and Noland under Special Contract dated May 4, 1887. Record states: Set basalt stone, 12 x 10 x 6 ins., 8 ins. in the ground for 1/4 sec. cor. marked 1/4 on W. face. Dug pits, 18 x 18 x 12 in., N. and S. of stone, 5 1/2 ft. dist., raised mound of earth 1 1/2 ft. high, 3 1/2 ft. base over it.

I find no record of recovery or re-establishment by C.E. Redfield, U.S. Indian Service Surveyor, in the available Redfield Notes.

MONUMENT AND ACCESSORIES FOUND: None. Corner falls in centerline of Motanic Road.

MONUMENT MARKING DETAIL:

T1N R33E
1/4
S17 | S16
2005
PLS 1106

MONUMENT SET:

Re-established by single proportion measurement between the recovered Southwest and Northwest corners of Section 16. At re-established corner position, set a 2 1/2" brass cap on 2 1/2" by 30" galvanized iron pipe with cap buried 10" below ground level in gravel road. Corner falls in center on Motanic Road, in line with ditch and field line to the East and field lines extending West.

New accessories:

- A 5/8" x 30" rebar with a 1 1/4" yellow plastic cap marked "OR PLS 1106, WA PLS 17372", bears North 75° East, 25.8 feet.
 - A 5/8" x 30" rebar with a 1 1/4" yellow plastic cap marked "OR PLS 1106, WA PLS 17372", bears South 36° East, 28.9 feet.
 - A 5/8" x 30" rebar with a 1 1/4" yellow plastic cap marked "OR PLS 1106, WA PLS 17372", bears S 89°58'22" W, 30.00 feet. Set steel fence post 0.5 feet West of rebar accessory with "witness" sign attached.
 - A 5/8" x 30" rebar with a 1 1/4" yellow plastic cap marked "OR PLS 1106, WA PLS 17372", bears South 16 1/2° West, 55.3 feet.
- Attached bearing object signs to all rebar accessories.

LOCATION AND COMMENTS:

Corner falls in centerline of Motanic Road with a ditch line East and field line West.

FIRM: William R. Wells, PLS
P.O. Box 1696
Pendleton, OR 97801

COMPASS DECLINATION: 18° East

Surveyor's Seal

Witnesses: Jason Wells, LSIT

\IN33L09

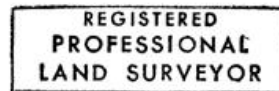

William R. Wells

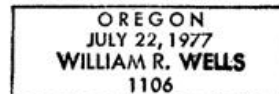

RENEWED 30-06

Umatilla County Surveyor.

Date 6-05

Rec'd By KK