

OREGON CORNER RESTORATION FORM

Section 34 Township 1N Range 32E
County Umatilla Date: July 29, 2009

Corner Designation: 1N32Z17 Condition Report Only
Not found
Remonumented
Unrecorded
Surveyed in
Referenced out

South section corner to Sections 34 and 35 T1N, R32E
W.M., Umatilla County.

Previous Renewals / Surveys, etc.

Corner originally set by David P. Thompson under contract No. 79, dated July 26, 1858. His record reads: Set stone 15x10x10 ins for corner to secs. 34 and 35 and build mound. David L. Haddock in survey 97-140-C says: found a beautifully chiseled 15x10x10 rounded river stone. He set a 1.25" x 30" galvanized iron pipe with a 2.25" brass cap at the position of the stone.

Monument and Accessories found: (condition and source)
I found the brass cap as described by Haddock in good condition.

DIAGRAM

SKETCH

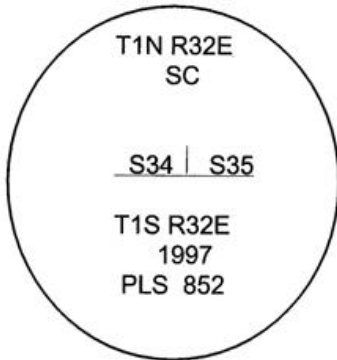

MONUMENT (S) AND ACCESSORIES SET (Procedures and Description)
None.

This monument was tied to report the Oregon State Plane, NAD 83/1991 coordinates only.

Measurements were made with a Trimble R7/R8 RTK GPS system.

Location and comments
NAD 83/1991 State Plane Coordinate
Oregon North Zone
N = 678,573.86 ift
E = 8,641,197.45 ift

Compass Declination
Firm / Agency
Witness Tree Surveying
Address
P.O. Box G
Pilot Rock, OR 97868
Party Chief
Stephen K, Haddock

Surveyors Seal

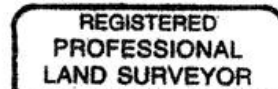

Stephen K. Haddock

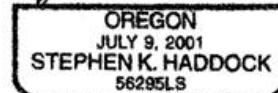

RENEWAL DATE 6-30-11

RECEIVED BY:
Umatilla County Surveyor
Date: 6-10
Rec'd By: KK
No. 10-93-C