

**OREGON CORNER RESTORATION FORM**

Section 35 Township 1N Range 32E  
 County Umatilla Date: June 30, 2009

Corner Designation: 1N32X21

Quarter corner common to sections 35 and 36,  
 T1N, R32E, W.M., Umatilla County, Oregon.

Condition Report Only  
 Not found  
 Remonumented  
 Unrecorded  
 Surveyed in  
 Referenced out

Previous Renewals / Surveys, etc.

Corner originally set by Daniel Chaplin under contract No. 107 Dated September 21, 1864.  
 His record reads: Set stone, 17x10x8, for 1/4 sec. corner. Zenas F. Moody under contract  
 No. 164 Dated October 4, 1871, stated: Set stone 18x14x7. Currin and Noland under special  
 contract Dated May 4, 1887, stated: Set basalt stone, 10x10x14 ins.

Monument and Accessories found: ( condition and source )  
 None. the corner falls in the fence line between plowed fields.

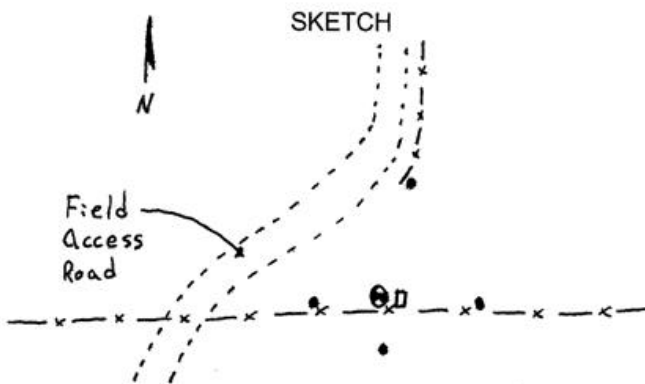
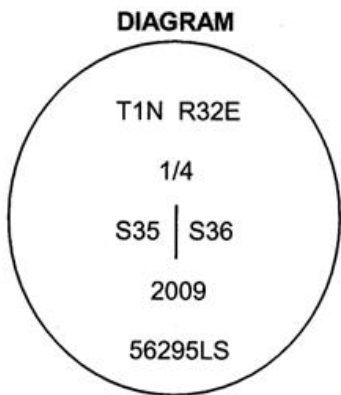

- ⊗ = Brass Cap
- = Rebar Reference
- = Steel Guard Post

**MONUMENT (S) AND ACCESSORIES SET (Procedures and Description)**

I Set a 1 1/2" x 30" galvanized iron pipe with a 2 1/2" brass cap stamped as shown in the diagram above at the intersection of the east - west fence line and the north - south section line.

For references, I set four 5/8" by 24" iron rebars with 1 1/4" orange plastic caps stamped WTS and 56295LS as described below:

- an iron rebar bears N03°56'14"E, 384.40 feet at the end of the existing field fence;
- an iron rebar bears N89°30'38"W, 72.21 feet under the existing fence;
- an iron rebar bears S89°29'40"E, 24.25 feet under the existing fence;
- an iron rebar bears S00°03'21"W, 48.60 feet 20 inches below the surface of the field.

The monument was set and references tied using a Trimble R7/R8 RTK GPS system.

Location and comments  
 NAD 83/1991 State Plane Coordinate  
 Oregon North Zone  
 N = 681,324.97 ft  
 E = 8,646,398.03 ft

Compass Declination  
 Firm / Agency  
 Witness Tree Surveying  
 Address  
 P.O. Box G  
 Pilot Rock, OR 97868  
 Party Chief  
 Stephen K, Haddock

Surveyors Seal

REGISTERED  
 PROFESSIONAL  
 LAND SURVEYOR

*Stephen K. Haddock*

OREGON  
 JULY 9, 2001  
 STEPHEN K. HADDOCK  
 56295LS

RENEWAL DATE 6-30-11

RECEIVED BY:  
 Umatilla County Surveyor  
 Date: 6-10  
 Rec'd By: KK  
 No. 10-95-C