

**OREGON CORNER RESTORATION FORM**

Section 29 Township 1N Range 32E  
County Umatilla Date: September 17, 2009

Corner Designation: 1N32V7

Quarter corner common to sections 29 and 32,  
T1N, R32E, W.M., Umatilla County, Oregon.

Previous Renewals / Surveys, etc.

Corner originally set by Daniel Chaplin under contract no. 107 dated September 21, 1864.  
His record reads: Set post for 1/4 sec. corner in mound of earth with charred stake, pits & c as per instructions.

Condition Report Only  
Not found  
 Remonumented  
Unrecorded  
 Surveyed in  
 Referenced out

Monument and Accessories found: ( condition and source )  
None. This point falls in a plowed field.

**DIAGRAM**

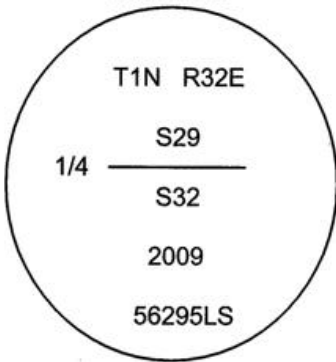

**SKETCH**

**MONUMENT (S) AND ACCESSORIES SET (Procedures and Description)**

At the proportioned point I set a 1 1/2"x30" galvanized iron pipe with a 2 1/2" brass cap stamped as shown in the diagram above. The cap is 24 inches below the surface of the field.

For references, I set four 5/8" by 24" iron rebars with 1 1/4" orange plastic caps stamped WTS and 56295LS as described below:

- an iron rebar bears N37°33'57"W, 36.59 feet, 2 feet below the surface of the field;
- an iron rebar bears N63°21'50"E, 27.89 feet, 2 feet below the surface of the field;
- an iron rebar bears S32°11'52"E, 84.03 feet;
- an iron rebar bears S64°47'07"W, 36.62 feet, 2 feet below the surface;

The monument was set and references tied using a Trimble R7/R8 RTK GPS system.

Location and comments  
NAD 83/1991 State Plane Coordinate  
Oregon North Zone  
N = 683,589.74 ift  
E = 8,627,877.36 ift

Compass Declination

Surveyors Seal

RECEIVED BY:  
Umatilla County Surveyor  
Date: 6-10  
Rec'd By: KK  
No. 10-93-C

Firm / Agency  
Witness Tree Surveying  
Address  
P.O. Box G  
Pilot Rock, Or. 97868  
Party Chief  
Stephen K, Haddock

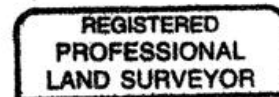

*Stephen K. Haddock*

