

**OREGON CORNER RESTORATION FORM**

Section 15 Township 1N Range 32E  
 County Umatilla Date: August 31, 2009

Corner Designation: 1N32L17

Condition Report Only  
 Not found

Quarter corner common to sections 14 and 15,  
 T1N, R32E, W.M., Umatilla County, Oregon.

Remonumented  
 Unrecorded  
 Surveyed in  
 Referenced out

Previous Renewals / Surveys, etc.

Corner originally set by Daniel Chaplin under contract No. 107 Dated September 21, 1864. His record reads: Set post for 1/4 section corner in mound of earth with charred stake, pits, etc., as per instructions. Currin and Noland under special contract dated May 4, 1887, found old 1/4 corner stone measuring 12x9x8 ins. In record of survey H-253-B, computed point. In Partition Plat 2009-19, Bill Wells proportioned this position but did not monument it.

Monument and Accessories found: ( condition and source )  
 None. This point falls in a wheat field.

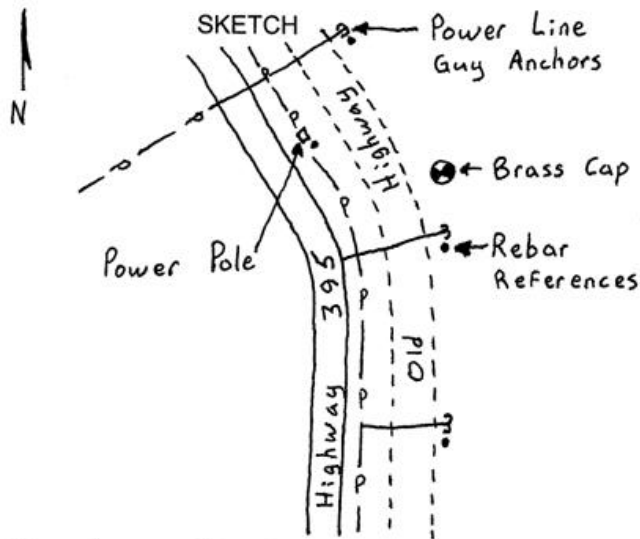
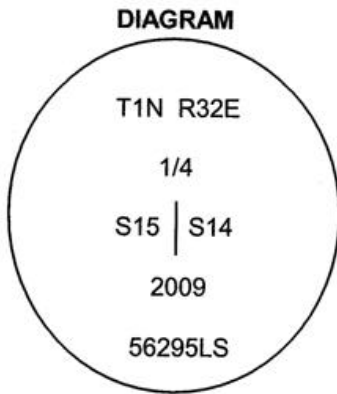

**MONUMENT (S) AND ACCESSORIES SET (Procedures and Description)**

Set a 1 1/2" x 30" galvanized iron pipe with a 2 1/2" brass cap stamped as shown in the diagram above at the point from Partition Plat 2009-19.

For references, I set four 5/8" by 24" iron rebars with 1 1/4" orange plastic caps stamped WTS and 56295LS as described below:

- an iron rebar bears N36°46'59"W, 465.89 feet just south of a power line guy anchor;
- an iron rebar bears N60°10'51"W, 275.15 feet;
- an iron rebar bears S51°50'54"W, 124.19 feet just south of a power line guy anchor;
- an iron rebar bears S02°17'36"W, 327.27 feet just south of a power line guy anchor;

The monument was set and references tied using a Trimble R7/R8 RTK GPS system.

Location and comments  
 NAD 83/1991 State Plane Coordinate  
 Oregon North Zone  
 N = 697,028.18 ift  
 E = 8,640,814.46 ift

Compass Declination  
 Firm / Agency  
 Witness Tree Surveying  
 Address  
 P.O. Box G  
 Pilot Rock, OR 97868  
 Party Chief  
 Stephen K, Haddock

Surveyors Seal

RECEIVED BY:  
 Umatilla County Surveyor  
 Date: 6-10  
 Rec'd By: JK  
 No. 10-63-C

REGISTERED  
 PROFESSIONAL  
 LAND SURVEYOR

*Stephen K. Haddock*

OREGON  
 JULY 9, 2001  
 STEPHEN K. HADDOCK  
 56295LS

RENEWAL DATE 6-30-11