

OREGON CORNER RESTORATION FORM

COUNTY: Umatilla DATE: 4/14/94

CORNER DESIGNATION: Z-9. Southwest corner Section 33, T2N.,
R32E., W.M.

PREVIOUS RENEWALS/SURVEYS, ETC.: Most recent official GLO survey was made by David P. Thompson, under Contract No. 106, dated August 16, 1864. Original notes state: set post for corner to secs. 4, 5, and 32 and 33 in mound of earth with charred stake, pits, trench & etc. per instructions.

MONUMENT AND ACCESSORIES FOUND: None. Corner falls at a fence intersection with fences extending North-South and West.

MONUMENT MARKING DETAIL:

T2N R32E
S32 — | — S33
S5 — | — S4
T1N
1994
PLS 1106

MONUMENT SET: After confirming by survey, accepted fence corner with fences extending North, South and West as the best remaining evidence of the original corner. Set a 2 1/2" brass cap on a 1 1/4" x 30" galvanized iron pipe, 28" in the ground, with mound of earth to cap, (marked as shown in the monument detail).

New Accessories:

Set steel fence post and witness sign 1.0 feet South of monument.
A 5/8" x 30" iron pin with yellow plastic cap stamped "OR PLS 1106-WA PLS 17372" bears N 2° E-19.6 feet.
A 5/8" x 30" iron pin with yellow plastic cap stamped "OR PLS 1106-WA PLS 17372" bears S 50° E-19.6 feet, top buried 1.2 feet.
A 5/8" x 30" iron pin with yellow plastic cap stamped "OR PLS 1106-WA PLS 17372" bears S 5° W-20.3 feet.
A brass washer nailed to power pole No. 10/28, 1 foot above ground, bears N 22° W-9.6 feet. The brass washer is stamped "PLS 1106".
Set steel fence posts near the iron pins above ground, with witness signs attached. Attached bearing object signs to iron pin reference monuments and power pole.

LOCATION & COMMENTS: Corner falls at fence intersection with fences extending North, South and West.

COMPASS DECLINATION: 18° East.
FIRM/AGENCY: William R. Wells, PLS
P.O. Box 1696
Pendleton, Oregon 97801

Surveyor's Seal

Party Chief: Robert D. English
Notes: Robert D. English
Witness: F. Scot Munro

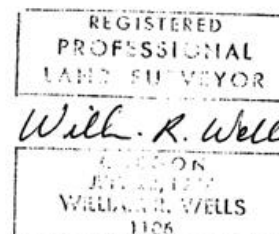

renews 12-31-94