

OREGON CORNER RESTORATION FORM

COUNTY: Umatilla DATE: 4/14/94

CORNER DESIGNATION: Z-13. Southeast corner Section 33, T2N., R32E., W.M.

PREVIOUS RENEWALS/SURVEYS, ETC.: Most recent approved GLO survey was made by David P. Thompson under Contract No. 106, dated August 16, 1864. Original notes state: set post for corner to secs. 3, 4, 33 and 34 in mound of earth with charred stake, pits, trench &c as per instructions. Staebler found remnants of corner post charcoal and set 3" capped pipe, May 5, 1973. Umatilla County Survey No. I-41-B.

MONUMENT AND ACCESSORIES FOUND: 3" pipe (capped) protruding 2" out of ground, per Survey No. I-41-B.

MONUMENT MARKING DETAIL:

T2N R32E
S33 | S34
S4 | S3
T1N R32E
1994
PLS 1106

MONUMENT SET: At position of found Staebler monument, set a 2 1/2" brass cap on a 1 1/4" x 30" galvanized iron pipe, 24" in the ground, with mound of dirt to cap. (marked as shown in the monument detail). Buried Staebler monument horizontally in the new monument mound.

New Accessories:

Attached witness sign to existing steel fence post, near monument.
A 5/8" x 30" iron pin with yellow plastic cap stamped "OR PLS 1106-WA PLS 17372" bears N 22° E-64.6 feet.
A brass washer nailed to power pole No. 030900, 6" above ground bears S 34° E-56.8 feet. Brass washer is stamped "PLS 1106".
A 5/8" x 30" iron pin with yellow plastic cap stamped "OR PLS 1106-WA PLS 17372" bears S 24° W-17.0 feet.
A 5/8" x 30" iron pin with yellow plastic cap stamped "OR PLS 1106-WA PLS 17372" bears N 33 1/2° W-16.6 feet.
Set steel fence posts near iron pin with witness sign attached.
Attached bearing object tag to iron pins and above brass washer.

LOCATION & COMMENTS: Corner falls on Southwest side of County Road.

COMPASS DECLINATION: 18° East.
FIRM/AGENCY: William R. Wells, PLS
P.O. Box 1696
Pendleton, Oregon 97801

Surveyor's Seal

Party Chief: Robert D. English
Notes: Robert D. English
Witness: F. Scot Munro

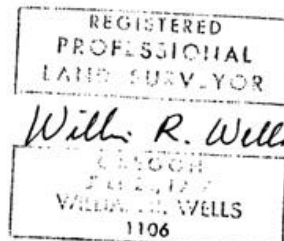

renews 12-31-94