

TOMKINS LAND SURVEYING, INC.
20 EAST POPLAR, SUITE 204
WALLA WALLA WA 99362
PHONE: 509/522-4843
FAX 509/522-1902
email: tomkins@wwics.com

JUNE 17, 1998

HORIZONTAL CONTROL DATA

STA. NAME: 919

LOCATION: TOWNSHIP 5 NORTH, RANGE 35 EAST, WILLAMETTE MERIDIAN. S.E. 1/4 OF SECTION 24.

DESCRIPTION: ½" REBAR WITH A RED PLASTIC CAP STAMPED "TOMKINS CONTROL" SET 4' WEST OF THE WEST EDGE OF NICHOLS CANYON ROAD APPROXIMATELY ON THE EAST-WEST CENTERLINE OF SECTION 24.

GEODETTIC COORDINATE: NAD 83(91)

LAT: 45°53'46.06381" N.

LONG: 118°22'54.19700" W.

STATE PLANE COORDINATE: NAD 83(91) OREGON NORTH ZONE (3601)

N: 249904.548 METERS

E: 2664372.721 METERS

N: 819896.811 INT. FEET

E: 8741380.310 INT. FEET

ELEVATION: 438.66 METERS

1439.16 FEET

ELEVATION DATUM: NAVD 88

THETA: 1°30'08.1"

GRID FACTOR: 0.999975249

SEA LEVEL FACTOR: 0.999931165

COMBINED SCALE FACTOR: 0.999906416

CONVERSION:

METERS X 3.28083333333 = U.S. FEET

METERS X 3.28083989501 = INTERNATIONAL FEET

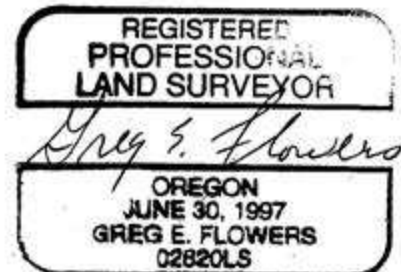

RENEWS 12/31/99

6/17/98