

**BASIS OF BEARINGS**

BEARINGS ARE BASED ON A SOLAR OBSERVATION MADE NEAR THE WITNESS CORNER ALONG THE EAST-WEST CENTERLINE OF SECTION 20, USING THE HOUR ANGLE METHOD, AND ARE CONSISTENT WITH THOSE BEARINGS SHOWN ON MAPPING FOR UMATILLA FOREST POSTING CONTRACT 53-04R3-2-20.

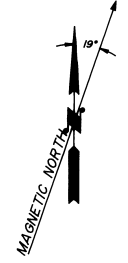

**B.L.M. SURVEY LINE**

NO.	BEARING	DISTANCE
L6	S 89°54'00" W	101.64'
L7	S 47°13'30" W	60.72'
L8	S 25°11'30" W	213.51'
L9	S 52°04'30" W	162.03'

FD. 2" PIPE WITH 3" B.L.M. BRASS CAP STAMPED "1/4 S20/S21 1991" FROM WHICH A 24" WHITE FIR WITH BLAZE AND BLM B.T. TAG BEARS S52°15'W 25.1 FT. AND A 20" WHITE FIR WITH BLAZE AND BLM BT TAG BEARS EAST 18.2 FT.

SET 2 1/2" ALUMINUM PIPE WITH 2 1/2" CAP FOR TRACT CORNER FROM WHICH A 13" WHITE FIR, SCRIBED "BT" BEARS N40°11'W 15.5' AND A 25" WHITE FIR SCRIBED "BT" BEARS S47°56'E 94.3 FT. FROM THE CORNER. CAP IS STAMPED "PLS 2360 1994."

**THREAD OF HENRY CREEK**

NO.	BEARING	DISTANCE
L1	N 61°19'25" E	29.98'
L2	N 20°12'40" E	169.30'
L3	N 37°55'45" E	29.73'
L4	N 70°49'07" E	47.50'
L5	N 13°39'04" E	41.93'

**VICINITY MAP**  
NO SCALE

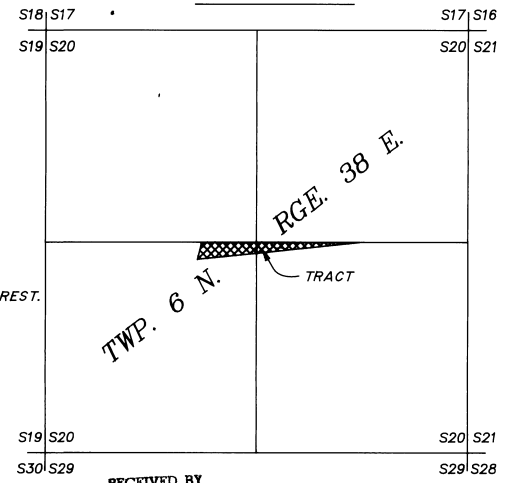

**LEGEND**

- TRACT BOUNDARY
- 1/4 SECTION LINE
- ROAD CENTERLINE
- CREEK CENTERLINE
- FENCE LINE
- FOUND OR SET SURVEY MONUMENT AS DESCRIBED
- (XOX) RECORD DIMENSION PER BLM 1993 PLAT OF T.6N R.38E
- BLM BUREAU OF LAND MANAGEMENT
- CL CENTERLINE

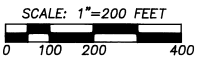

**APPROVALS**

EXAMINED AND ACCEPTED FOR THE U.S. FOREST SERVICE.  
*Dennis K. Gaylord*  
 FOREST LAND SURVEYOR  
 DATE: May 18, 1995

I CERTIFY THAT THIS SURVEY WAS PERFORMED AT THE REQUEST OF THE UMATILLA NATIONAL FOREST.

*John P. Klein*  
 NATIONAL FOREST SUPERVISOR  
 DATE: 5/18/95

NOTE: THIS TRACT IS CREATED FOR CONVEYANCE UNDER THE QUITCLAIM ACT OF APRIL 28, 1930 (46 STATUTE 256; 43 U.S.C. 872.)

**SURVEYOR'S CERTIFICATE AND NARRATIVE**

I, PAUL W.P. TOMKINS, A REGISTERED LAND SURVEYOR IN THE STATE OF OREGON UNDER LICENSE NO. 2360, DO HEREBY CERTIFY THAT THIS PLAT IS A CORRECT REPRESENTATION OF A SURVEY PERFORMED BY ME IN AUGUST, 1994. THIS SURVEY WAS PERFORMED AT THE REQUEST OF U.S.D.A., FOREST SERVICE, AND IN ACCORDANCE WITH THE ARTICLES OF MY CONTRACT.

CONTROL WORK WAS ORIGINALLY PERFORMED IN 1991 UNDER POSTING CONTRACT 53-04R3-2-20, AND ADDITIONAL TRAVERSES WERE PERFORMED IN AUGUST OF 1994. MEASUREMENTS WERE MADE USING A SOKKIA AND A NIKON AUTOMATIC TOTAL STATION, BOTH HAVING STANDARD ERRORS OF 3 MILLIMETERS ± 2 PARTS PER MILLION AND 0°00'03". THE SURVEY WAS PERFORMED AS A CLOSED FIELD TRAVERSE AND WAS ADJUSTED USING LEAST SQUARES.

REFERENCE IS MADE HEREIN TO THE B.L.M. RESURVEY OF THIS TOWNSHIP. THE MONUMENT SET BY MR. GAYLORD, SHOWN HEREIN, IS DESCRIBED IN A LAND CORNER RECORD FILED IN THE OFFICE OF THE UMATILLA COUNTY SURVEYOR UNDER FILE NO. 94-66-R.

RECEIVED BY  
 Umatilla County Surveyor  
 Date: 6-95  
 Rec'd by: KR  
 No. 72-94-B

SHEET 1 OF 1

RECORD OF SURVEY OF A TRACT LOCATED IN THE SOUTH 1/2 OF SECTION 20, TWP. 6 NORTH, RGE. 38 EAST, W.M. UMATILLA COUNTY, OREGON

FOR: USDA FOREST SERVICE 2517 S.W. HAILEY AV. PENDLETON, OR 97601

PAUL W.P. TOMKINS, LAND SURVEYOR  
 6 1/2 N. SECOND SUITE 303  
 WALLA WALLA, WA. 99362  
 (509) 522-4843  
 KLICKEKRL.DWG

DATE:  
**MAY, 1995**  
 SCALE:  
 1" = 200'

REGISTERED PROFESSIONAL LAND SURVEYOR  
 OREGON  
 JULY 26, 1988  
 PAUL W.P. TOMKINS  
 2360  
 RENEWS 6/30/96  
 5/18/95