

Q-599-Ax

North Line Section 10-4N-R.28 E.  
N. 89-31 W

40'

Oak Street

40'

61.54

7

Note:

1/2" Iron Pins At 4  
Corners.

50'

90°-14'

State Highway  
N. 0°-15' E.

50'

Scale 1" = 50'

N E 18

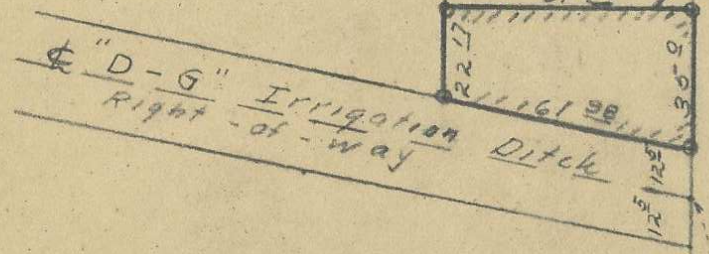

Winona Addn.

Jenny Ave.

Rock + Initial Point  
Winona Addition

C. H. Storms & Associates

CONSULTING ENGINEERS — ARCHITECTS

304 DENNY BUILDING TELEPHONE 4170 WALLA WALLA, WASH.

- Mechanical
- Structural
- Hydraulic
- Sanitary
- Designs
- Land Surveys
- House Plans
- Blue Prints
- Estimates

A SURVEY OF  
PART OF LOT 7 OF  
BLK 15 OSBURN TRACTS  
HERMISTON, OREGON.  
LADD SHERMAN

Date 11/12/48  
Drawn By G.M.N.  
Checked By C.W.S.

# 710

SHEET 1 OF 1