

S.E. GOODWIN AVE.

60'

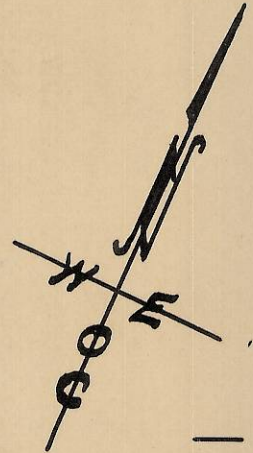
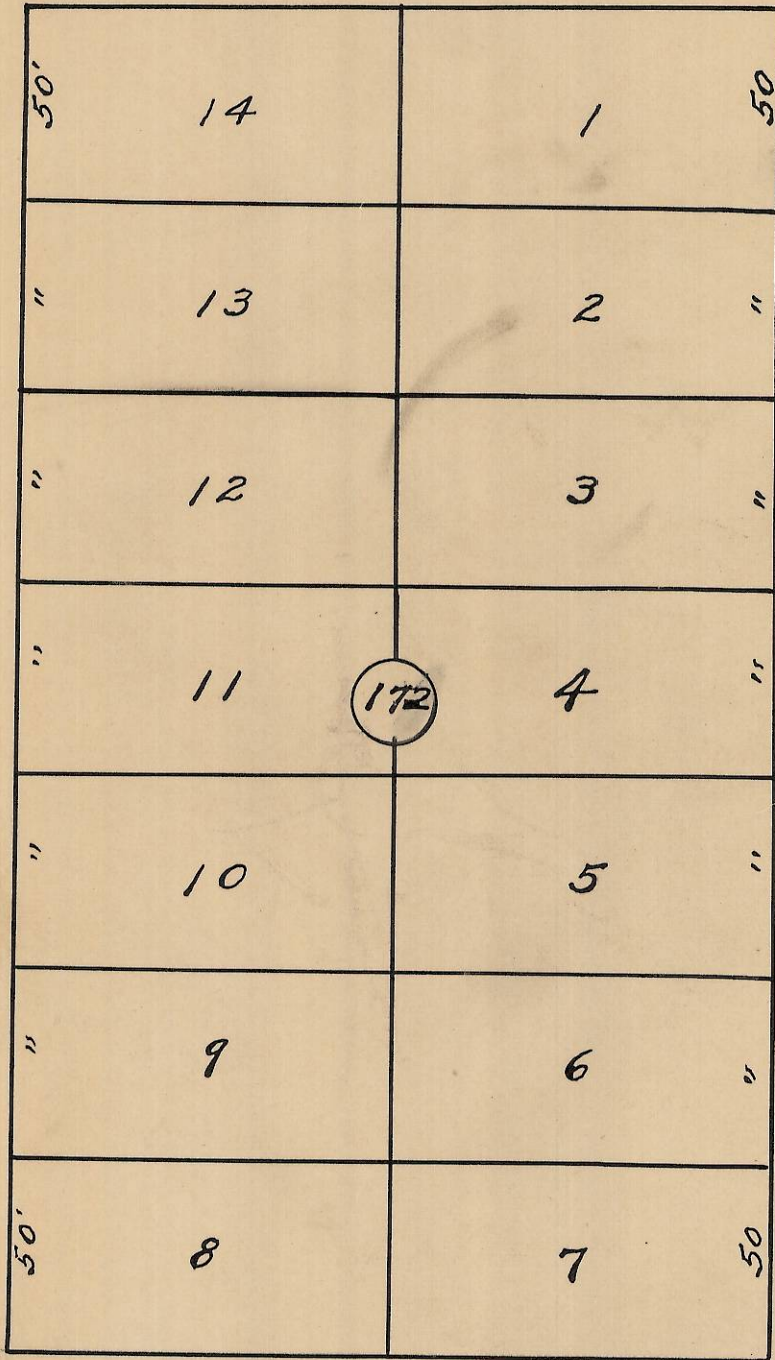

Plat of
 Block 172 of
 Reservation Addition
 to the town, now City
 of Pendleton, Oregon.
 Scale: - 1 inch = 50 Feet
 Surveyed, staked & platted
 Oct. 1948 - By W.E.O. Criger.

S.E. 8th St.

S.E. 9th St.

S.E. HAILEY AVE.

60'

60'

Rec'd. 2/21/13
 J. Roberts
 13-087-Ax

60'

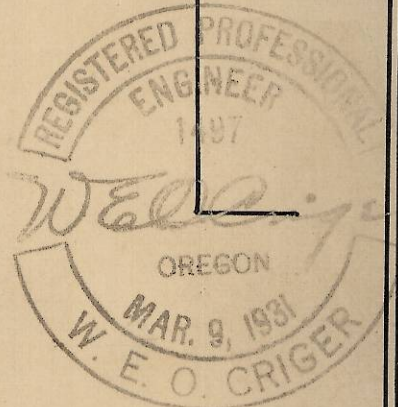

2N 3211 BD