

41059-278

55

R 15

LOW

L W

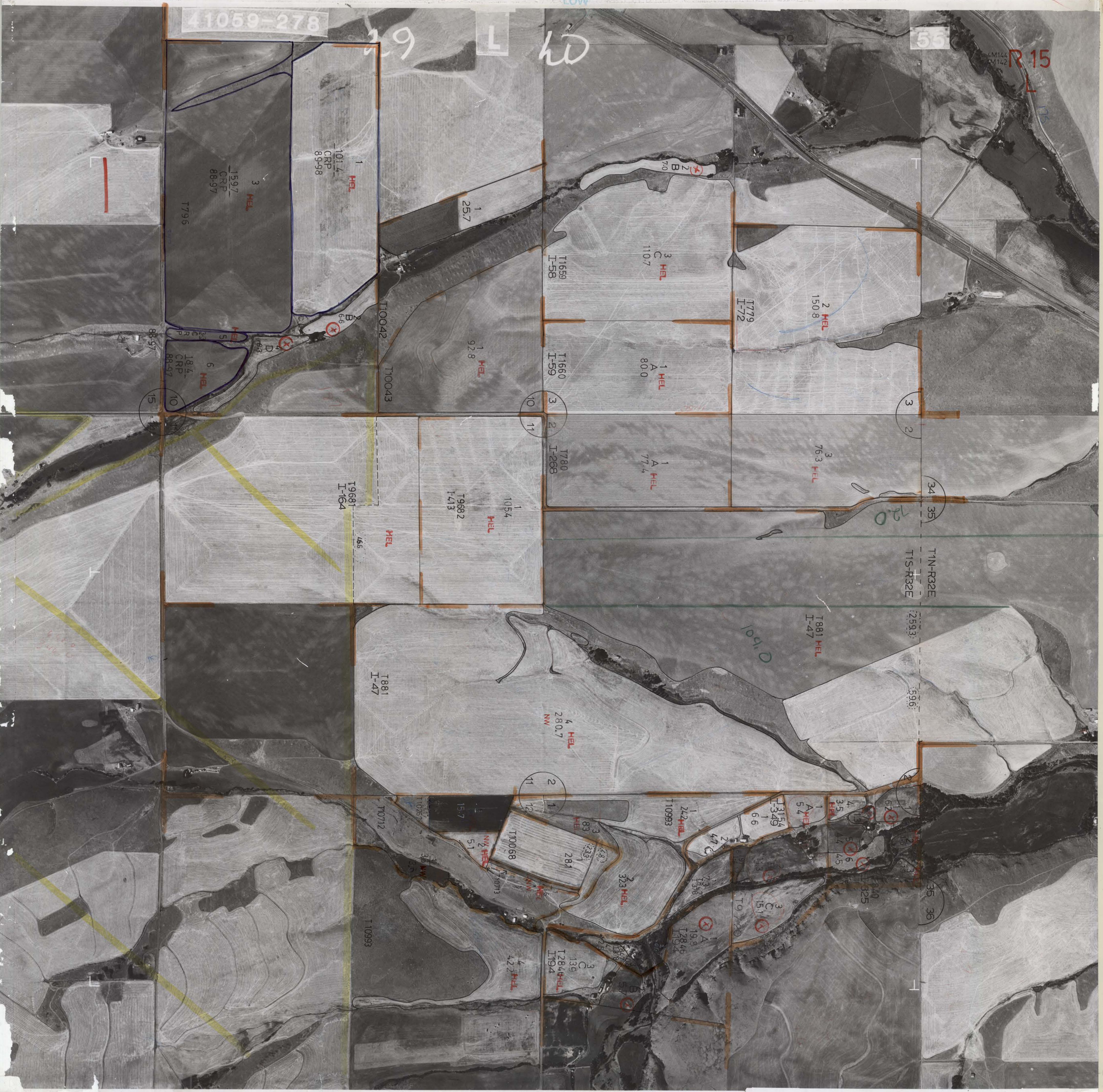

3
HEL
1597
CRP
88-97

1
HEL
101.4
CRP
89-98

1
25.7

3
HEL
110.7
C
I-58

1
HEL
80.0
A
I-59

2
HEL
150.8
I-72

6
HEL
18.4
CRP
88-97

1
HEL
92.8

1
HEL
77.4
A
I-268

3
HEL
76.3

1
HEL
105.4
19682
1413

1
HEL
19681
I-164

1
HEL
1881
I-47

4
HEL
280.7
NW

1
HEL
1881
I-47

1
HEL
22.2
I-10993

4
HEL
42.2
I-10993

3
HEL
139
128.4
I-194

1
HEL
19.8
I-2845

3
HEL
15.1
I-325



15

10

3

34

T1N-R32E

2593

596

2

2

35

36

M144

M142

15