

Rhd
ML
2M10
5M10

41059-378
62

T2N-R27E T2N-R28E

chester 2881
Prior

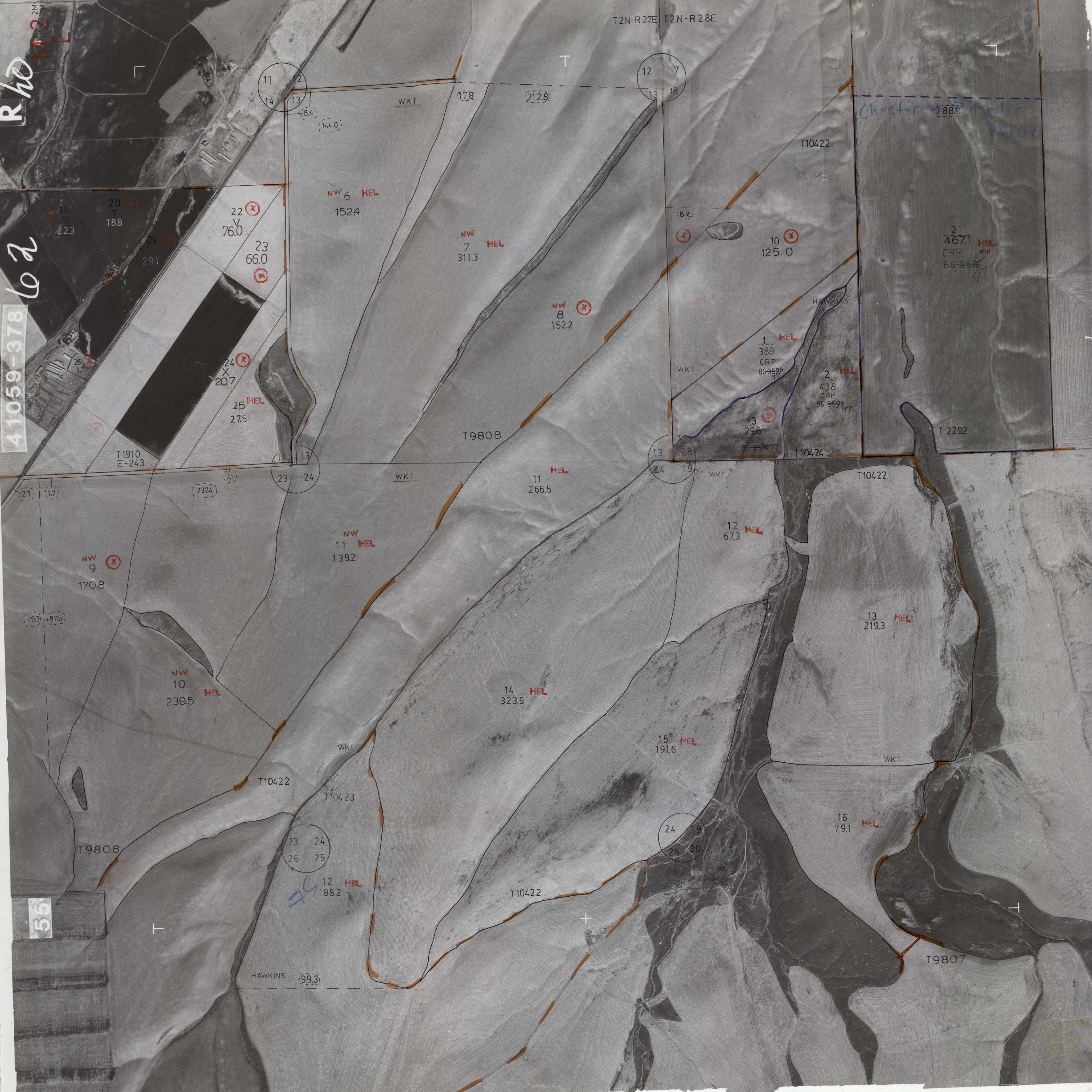

2
467.1
CRP
86-9596

1
389
CRP
86-9596

2
438
CRP
86-9596

3
296
CRP
86-9596

NW
9
170.8

NW
10
239.5

NW
11
139.2

14
323.5

15
191.6

16
79.1

12
188.2

HAWKINS
99.3

55

5