

TOWNSHIP 5 N., RANGE 36 E.W.M. UMATILLA COUNTY OREGON

SCALE 2 IN. = 1 MILE
DATED 1932

CHAS. F. METSKER CIVIL ENGINEER
215 COMMERCE BLDG. PORTLAND, ORE.
930 1/2 PACIFIC AVE. TACOMA, WASH.

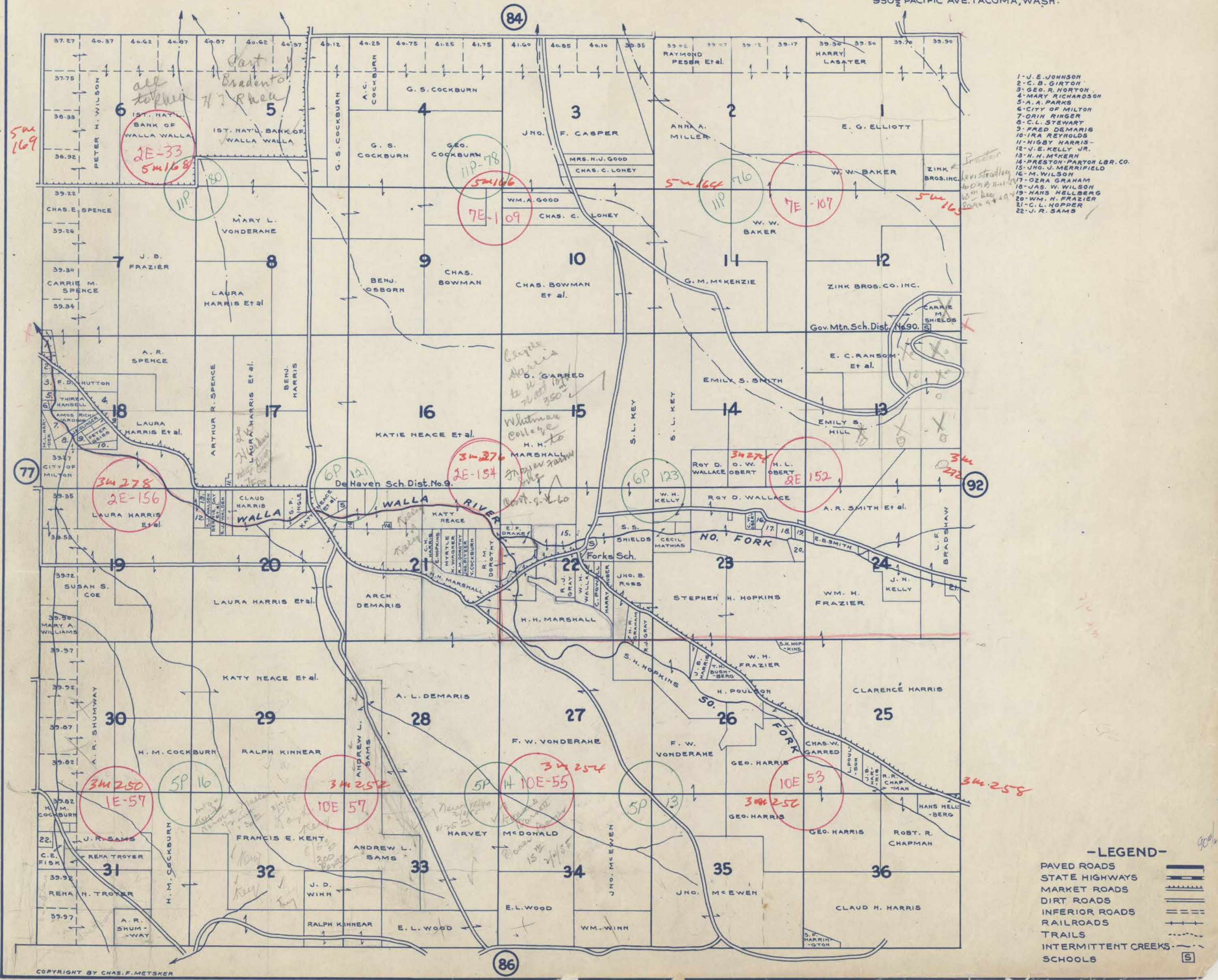

- 1-J. E. JOHNSON
- 2-C. B. GORTON
- 3- GEO. R. HORTON
- 4-MARY RICHARDSON
- 5-A. A. PARKS
- 6-CITY OF MILTON
- 7-ORIN RINGER
- 8-C. L. STEWART
- 9-FRED DEMARIS
- 10-IRA REYNOLDS
- 11-HIGBY HARRIS
- 12-J. E. KELLY JR.
- 13-H. H. MCKERN
- 14-PRESTON PARTON LBR. CO.
- 15-JNO. J. MERRIFIELD
- 16-M. WILSON
- 17-OZRA GRAHAM
- 18-JAS. W. WILSON
- 19-HANS HELMBERG
- 20-WM. H. FRAZIER
- 21-C. L. HOPPER
- 22-J. R. SAMS

- LEGEND-**
- PAVED ROADS
 - STATE HIGHWAYS
 - MARKET ROADS
 - DIRT ROADS
 - INFERIOR ROADS
 - RAILROADS
 - TRAILS
 - INTERMITTENT CREEKS
 - SCHOOLS