

10E-123

10A-62

NZ-6MM-183

Z 8

6M-170
T3S-R30E

23 24
26 35

21 22
28 27

22 23
27 26

26 25
35 36

27 26
34 35

6M-185

6M-181

28 27
33 34

F
7.9

-I-35-

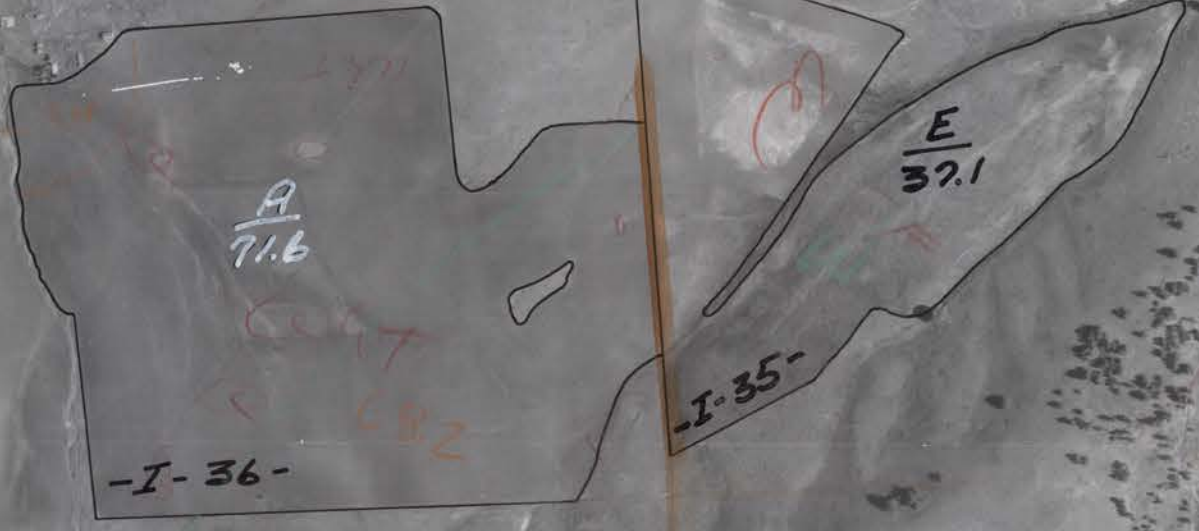

Handwritten note: Fall
Whisker Cut for hay
13.5 A

7-17-71

33 34
4 3

34 35
3 2

36 36
2 1

6M-209

10E-37A