

# TOWNSHIP 3 N., RANGE 36 E.W.M.

## UMATILLA COUNTY OREGON

SCALE 2 IN. = 1 MILE.  
DATED 1932

CHAS. F. METSKER CIVIL ENGINEER  
215 COMMERCE BLDG., PORTLAND, ORE.  
990 1/2 PACIFIC AVE., TACOMA, WASH.

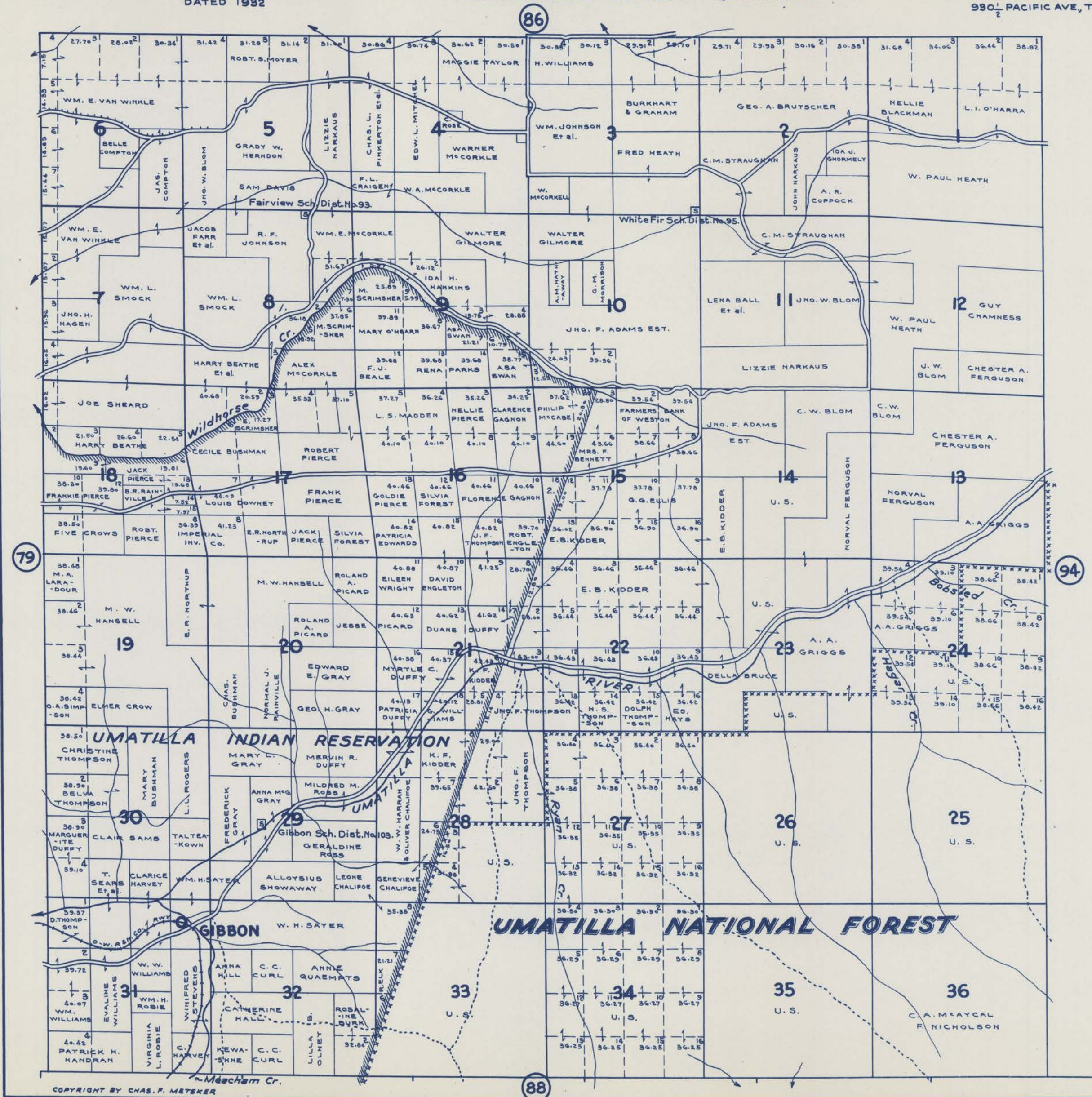

1-U. P. STOFFLE  
2-U. F. THOMPSON

**- LEGEND -**

- PAVED ROADS
- STATE HIGHWAYS
- MARKET ROADS
- DIRT ROADS
- INFERIOR ROADS
- RAILROADS
- TRAILS
- INTERMITTENT CREEKS
- SCHOOLS