

# TOWNSHIP 2 S., RANGE 35 E.W.M.

SCALE 2 IN. = 1 MILE.  
DATED 1932

UMATILLA COUNTY OREGON

CHAS. F. METSKER CIVIL ENGINEER  
215 COMMERCE BLDG., PORTLAND, ORE.  
980 1/2 PACIFIC AVE., TACOMA, WASH.

T. 2 S. 82 R. 35 E.

T. 6 S. R. 35 E.

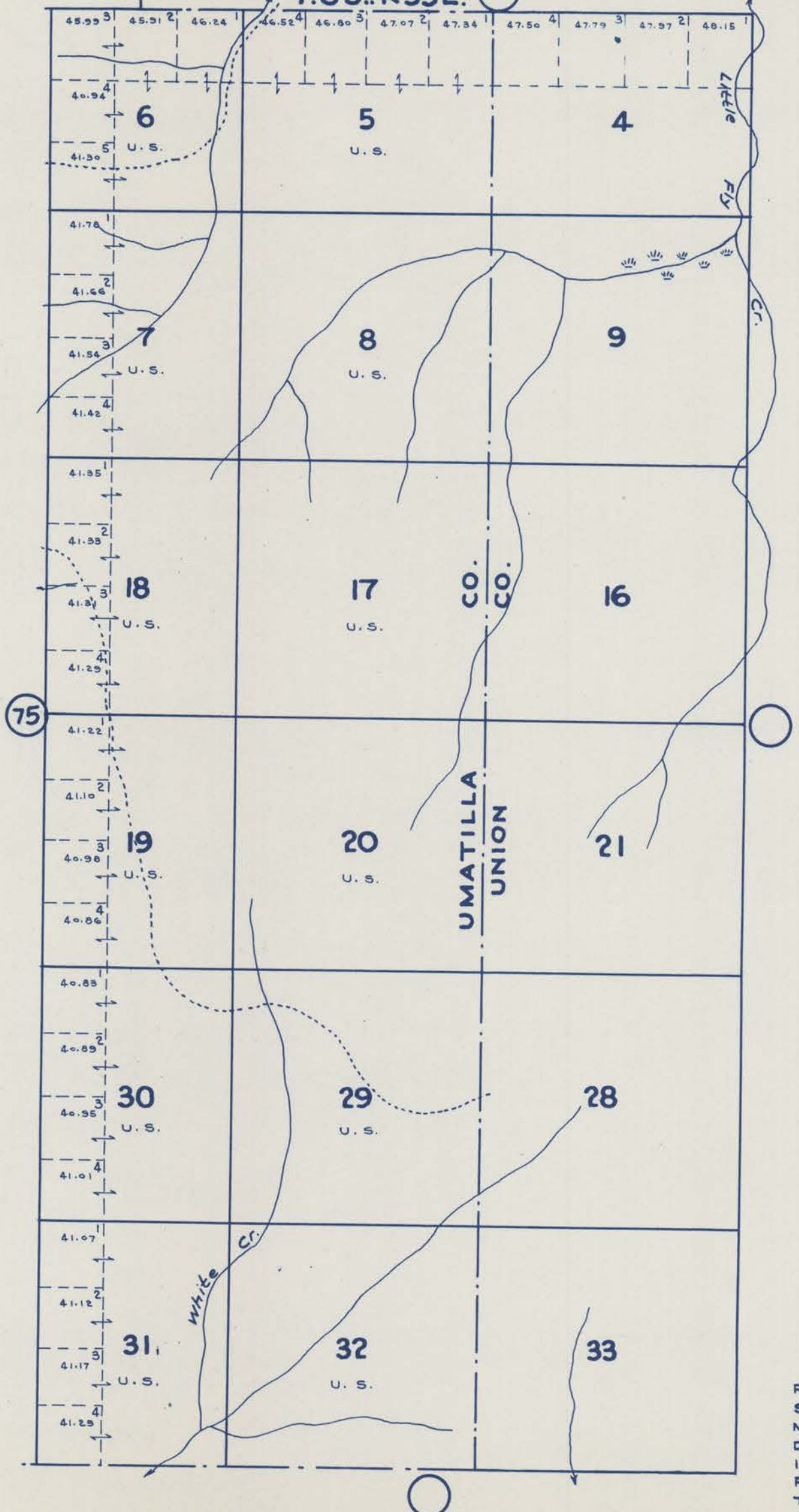
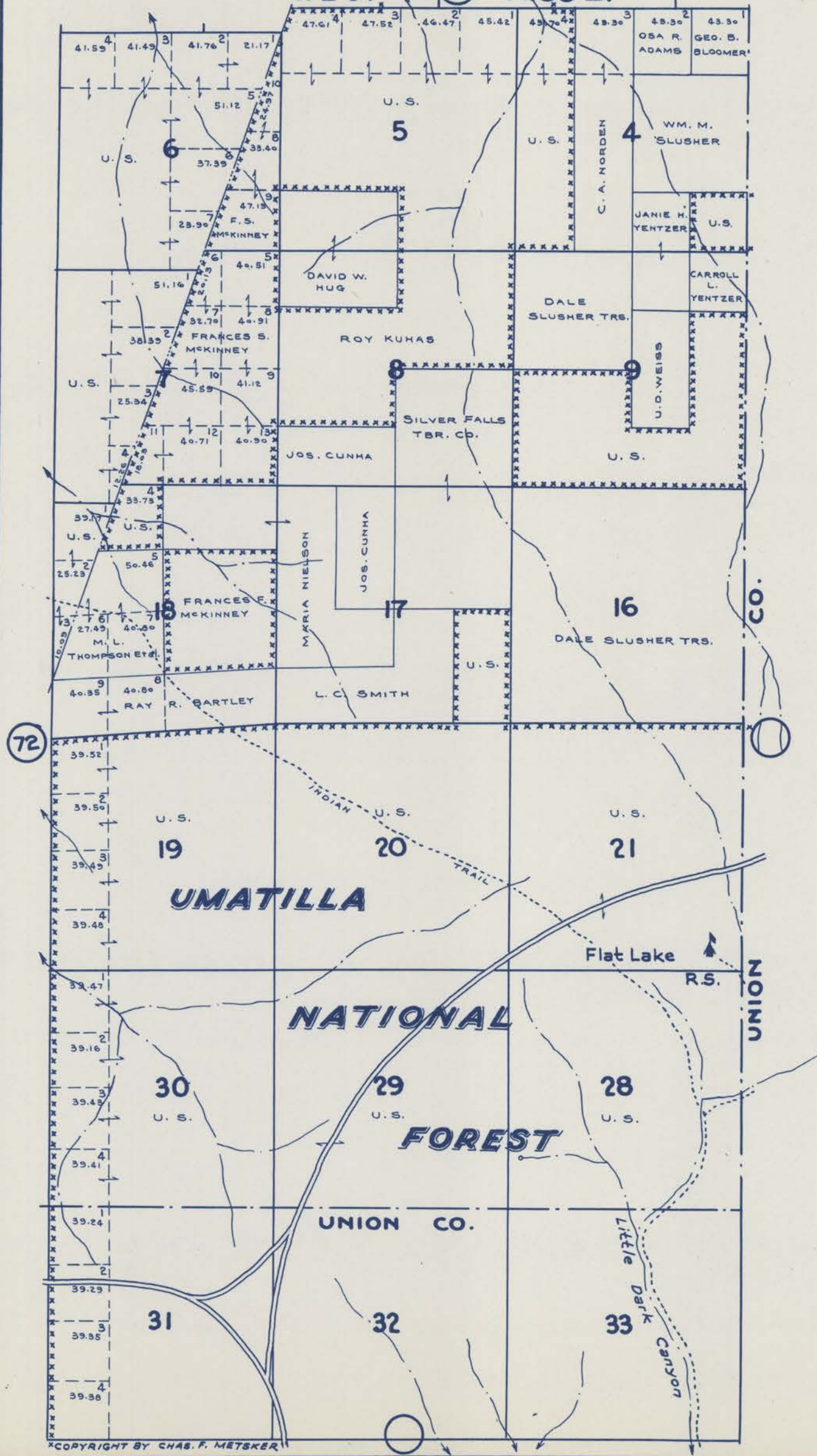

- LEGEND -**
- PAVED ROADS
  - STATE HIGHWAYS
  - MARKET ROADS
  - DIRT ROADS
  - INFERIOR ROADS
  - RAILROADS
  - TRAILS
  - INTERMITTENT CREEKS
  - SCHOOLS

NOTE: THIS TWP. ENTIRELY WITHIN UMATILLA NATL. FOREST.