

# TOWNSHIP 4 N., RANGE 35 E.W.M.

SCALE 2 IN. = 1 MILE.  
DATED 1932

## UMATILLA COUNTY OREGON

CHAS. F. METSKER CIVIL ENGINEER  
215 COMMERCE BLDG., PORTLAND, ORE.  
930 1/2 PACIFIC AVE., TACOMA, WASH.

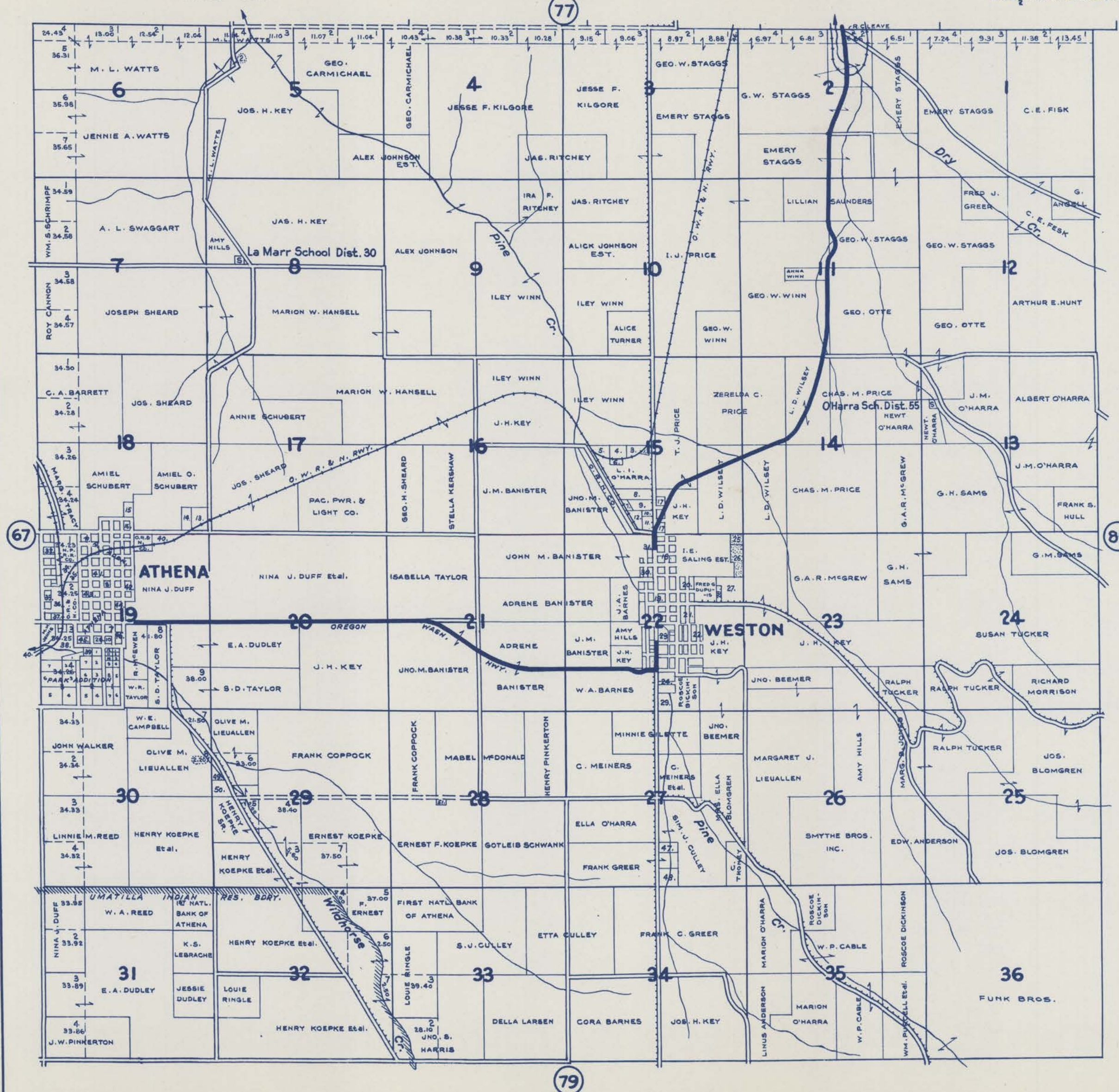

- 1 - WM. W. LATHAM
- 2 - M. L. WATTS
- 3 - WM. W. LATHAM
- 4 - " " "
- 5 - " " "
- 6 - " " "
- 7 - " " "
- 8 - L. I. O'HARRA
- 9 - WM. JOHNSON
- 10 - OLIVE O'HARRA
- 11 - HETTIE POWERS Etl.
- 12 - I. E. SALING
- 13 - A. O. SCHUBERT
- 14 - " " "
- 15 - A. C. RUSSELL
- 16 - A. O. SCHUBERT
- 17 - U. D. GISH ADD.
- 18 - SALING ADD.
- 19 - WESTON
- 20 - SALING & REESE ADD.
- 21 - HARTMAN ADD.
- 22 - KILGORE ADD.
- 23 - McARTHURS ADD.
- 24 - Mc MORRIS ADD.
- 25 - A. F. A. M. CEMETERY
- 26 - I. O. O. F.
- 27 - HENRY SCHROEDER
- 28 - NELLIE BORN
- 29 - JOHN BONEWITZ
- 30 - MAYS ADD.
- 31 - MOOREHOUSE ADD.
- 32 - KNOWLTONS ADD.
- 33 - ROSES ADD.
- 34 - PRESTON & PARTON MILL CO.
- 35 - NINA J. DUFF
- 36 - A. H. KIBBEY
- 37 - N. P. CO.
- 38 - M. W. HANSEL
- 39 - S. D. TAYLOR
- 40 - CITY OF ATHENA
- 41 - KIRKS 2ND ADD.
- 42 - " 4TH "
- 43 - " 1ST "
- 44 - " 3RD "
- 45 - RICHARDS ADD.
- 46 - O. R. & N. CO.
- 47 - LOUIS P. GILLILAND
- 48 - CECIL H. GREER
- 49 - A. W. LOSSDON
- 50 - UMATILLA COUNTY
- 51 - CITY OF ATHENA

**- LEGEND -**

- PAVED ROADS
- STATE HIGHWAYS
- MARKET ROADS
- DIRT ROADS
- INFERRIOR ROADS
- RAILROADS
- TRAILS
- INTERMITTENT CREEKS
- SCHOOLS