

TOWNSHIP 6 S., RANGE 33 E.W.M. UMATILLA COUNTY OREGON

SCALE 2 IN. = 1 MILE
DATED 1932

CHAS. F. METSKER CIVIL ENGINEER
215 COMMERCE BLDG. PORTLAND, ORE.
930 1/2 PACIFIC AVE. TACOMA, WASH.

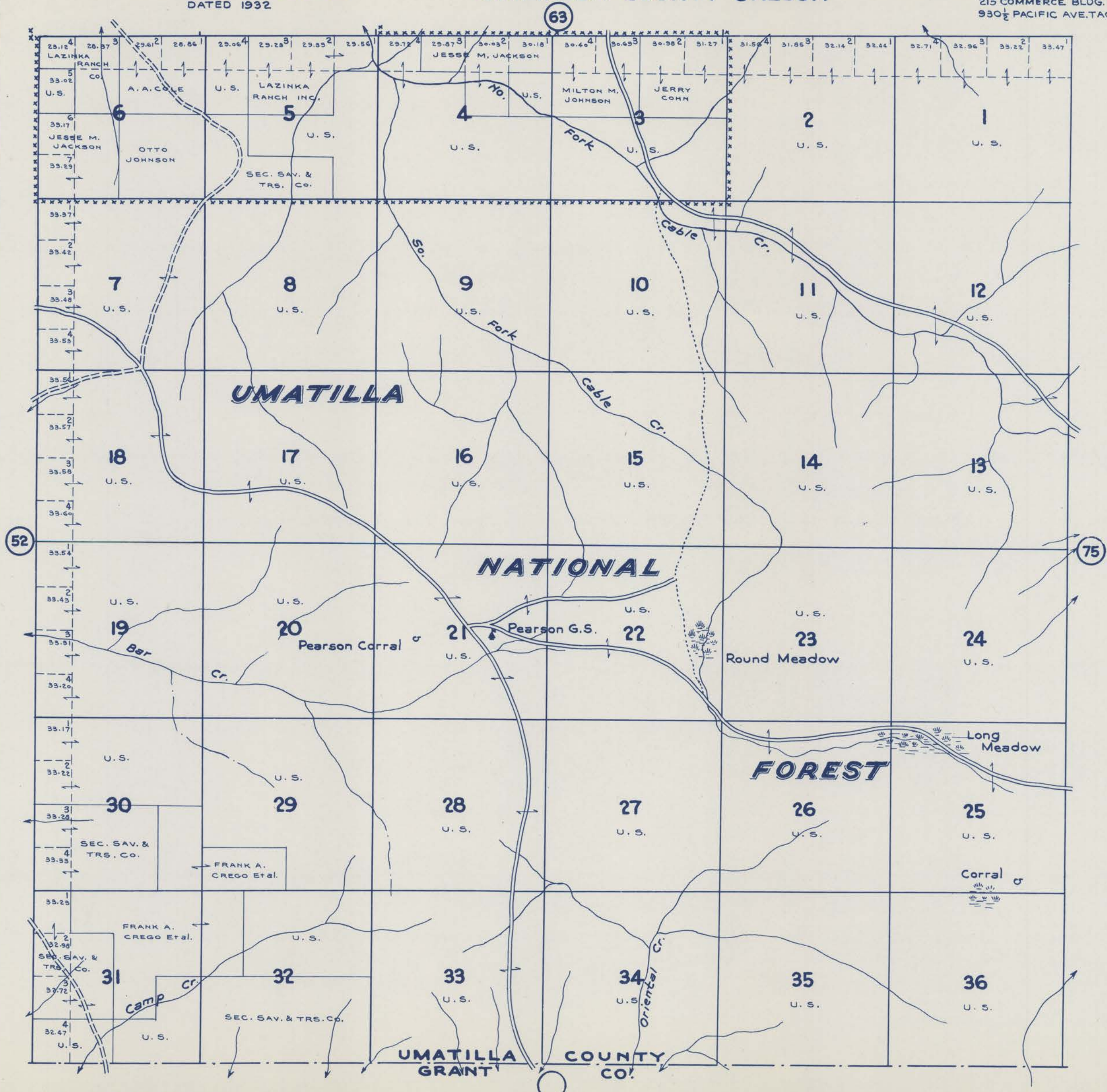

- LEGEND -

| | |
|---------------------|--|
| PAVED ROADS | |
| STATE HIGHWAYS | |
| MARKET ROADS | |
| DIRT ROADS | |
| INFERIOR ROADS | |
| RAILROADS | |
| TRAILS | |
| INTERMITTENT CREEKS | |
| SCHOOLS | |