

# TOWNSHIP 3 N., RANGE 33 E.W.M.

## UMATILLA COUNTY OREGON

SCALE 2 IN. = 1 MILE.  
DATED 1932

CHAS. F. METSKER CIVIL ENGINEER  
215 COMMERCE BLDG. PORTLAND, ORE.  
930 1/2 PACIFIC AVE. TACOMA, WASH.

1- J. E. TROXELL  
2- ED. LANNING  
3- V. B. PERRY  
4- PETER TACHELLA  
5- ROSE HARRAH

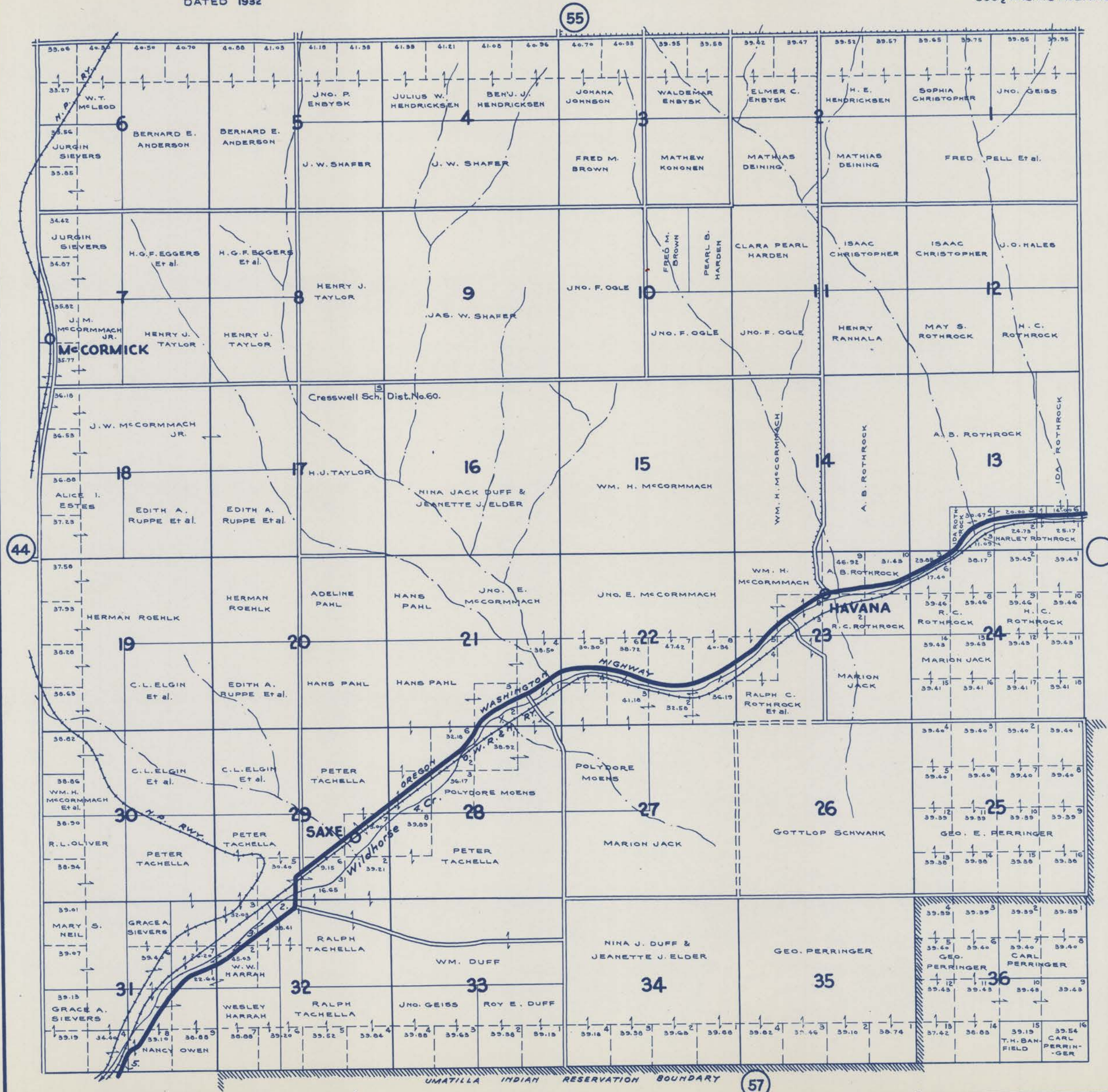

**- LEGEND -**

- PAVED ROADS
- STATE HIGHWAYS
- MARKET ROADS
- DIRT ROADS
- INFERIOR ROADS
- RAILROADS
- TRAILS
- INTERMITTENT CREEKS
- SCHOOLS