

P.O. 732 HC 3 miles

# TOWNSHIP 4 N., RANGE 28 E.W.M.

SCALE 2 IN. = 1 MILE  
DATED 1932

## UMATILLA COUNTY OREGON

CHAS. F. METSKER CIVIL ENGINEER  
215 COMMERCE BLDG. PORTLAND, ORE.  
930 1/2 PACIFIC AVE. TACOMA, WASH.

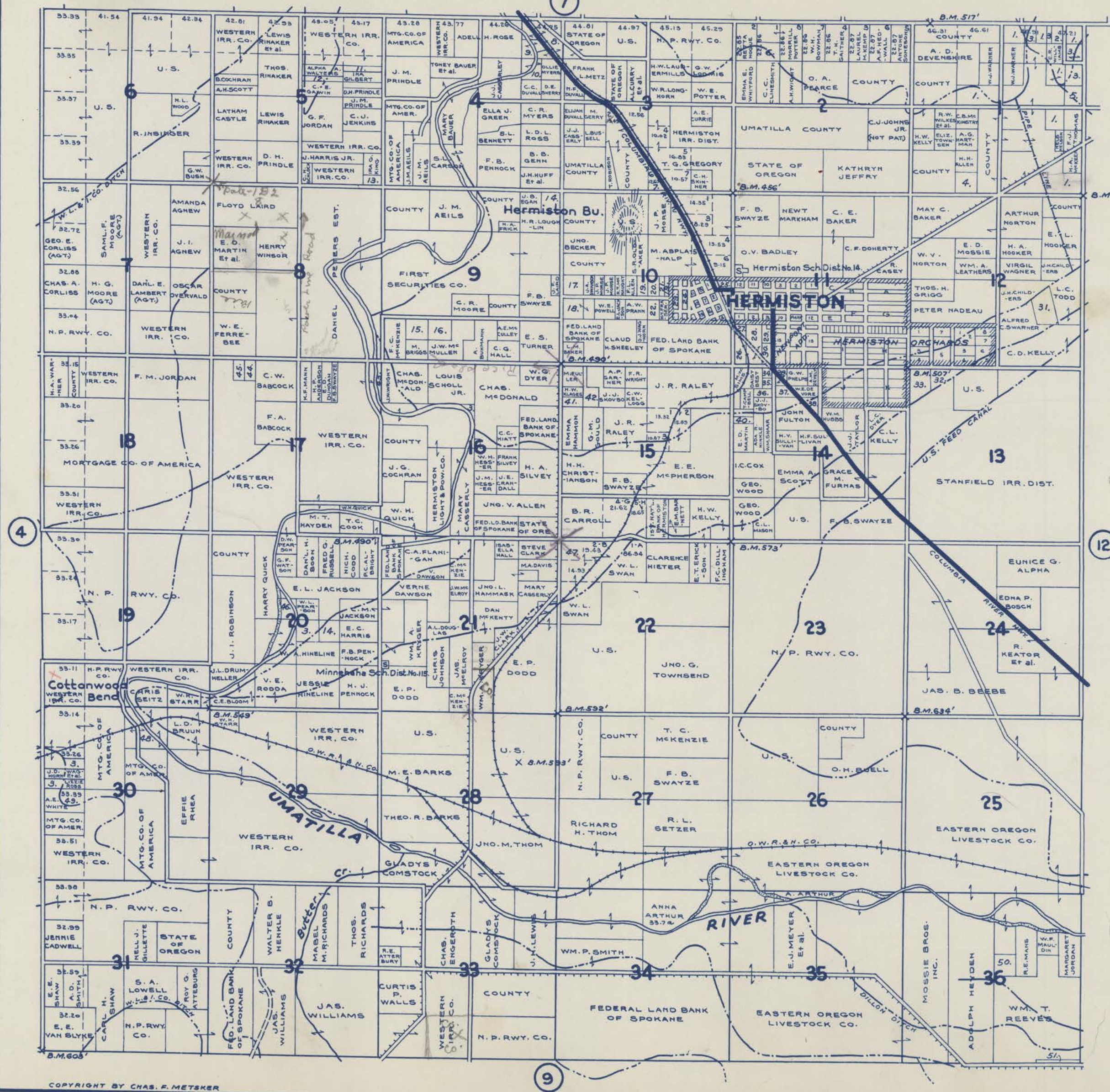

- 1-STANFIELD FEEDER CO.
- 2-R.G. ROSS
- 3-UMATILLA COUNTY
- 4-TUM A LUM LBR. CO.
- 5-JOHN BURNING
- 6-N. MADDEN
- 7-ANNA M. SMITH
- 8-MINNIE BENEDICT
- 9-MRS. J. BROWN
- 10-C.R. MYERS
- 11-ANNIE E.L. TAYLOR
- 12-L. & L. STEWART
- 13-C.A. PAGE
- 14-HERMISTON IRR. DIST.
- 15-INGLIS EMPIRE LBR. CO.
- 16-1ST. NATL. BK. OF ALBANY, ORE.
- 17-EDNA W. HUDDLESTON
- 18-THOMAS CAMPBELL
- 19-H.R. LAUGHLIN
- 20-S. R. OLDAKER
- 21-STANDARD OIL CO.
- 22-5 LOAN & SOUTHW.
- 23-1ST. ADD. TO HERMISTON
- 24-2ND. ADD. TO HERMISTON
- 25-KERN'S ADD. TO HERMISTON
- 26-CHAS. TAYLOR
- 27-CITY OF HERMISTON
- 28-EUGENE H. HANBY
- 29-W. J. WARNER
- 30-E. P. DODD
- 31-1ST. NATL. BK. OF HERMISTON
- 32-C. W. DYER ET AL.
- 33-LEWIS DOUGLAS ET AL.
- 34-AUG. F. BENDEL
- 35-H. M. STRAW
- 36-FRANKLIN MASON
- 37-T. L. STEWART
- 38-F. B. SWAYZE
- 39-LEWIS HIGGINS
- 40-C. E. WITTER
- 41-H. W. RATLIFF
- 42-RUTH T. MCNAUGHT
- 43-A. W. TURNBLAD
- 44-E. A. BABCOCK
- 45-ELIZ. BLAKELEY
- 46-L. C. QUICK
- 47-FED. L. BK. OF SPOKANE
- 48-U. L. DRUMHEALER
- 49-D. BURRELL
- 50-W. F. MAULDIN
- 51-FRANK DONNELLY

Right side of RR. Spokane bridge  
Road is see corner of 4N-28E, Sec  
16-15  
21-22

### -LEGEND-

- PAVED ROADS
- STATE HIGHWAYS
- MARKET ROADS
- DIRT ROADS
- INFERIOR ROADS
- RAILROADS
- TRAILS
- INTERMITTENT CREEKS
- SCHOOLS