

FILED
J. DEAN
CLERK

1987 APR 15 P 2:38

In the matter of amending the)
Umatilla County Development)
Ordinance #84-6 as amended by)
Ordinances #85-9 and #87-1 to)
reflect new road standards)

ORDINANCE #87-2

WHEREAS, The Umatilla County Road Department has simplified its road standards from 10 classifications to 5 classifications; and

WHEREAS, The County Road Department has requested that new roads and roads which will be arterial or collector roads have a 60 ft. right-of-way width; and

WHEREAS, The Umatilla County Development Ordinance does not reflect the simplified road classifications and only requires a 50 ft. road right-of-way; and

WHEREAS, Problems can be created between the two different standards as required by the Road Department and Development Ordinance; and

WHEREAS, The County Planning Commission discussed this matter with representatives of the Road Department in December of 1986 and agreed to call for a public hearing to amend the County Development Ordinance to be consistent with the Road Department standards; and

WHEREAS, On January 22, 1987 the County Planning Commission conducted a public hearing pursuant to the requirements listed in Chapter 15 of the Development Ordinance and recommended to the Board of County Commissioners that the standards be changed as requested by the Road Department; and

WHEREAS, A legal notice for the Planning Commission hearing appeared in the January 10, 1987 edition of the East Oregonian; and

WHEREAS, The Board of County Commissioners held a public hearing to review the proposed changes on March 17, 1987 and had concerns as to the need for 60 ft. rights-of-way for all roads, and therefore postponed a decision until April 1, 1987; and

WHEREAS, A legal notice for the March 17, 1987 hearing appeared in the March 6, 1987 edition of the East Oregonian; and

WHEREAS, On April 1, 1987 the Board reviewed additional testimony as provided by the Road Department and Planning Staff and decided to tie road rights-of-way to the Transportation Master Road Plan element of the Comprehensive Plan (which is in the process of being developed); and

WHEREAS, This approach would be consistent with the policies of the County's Comprehensive Plan;

NOW THEREFORE BE IT ORDAINED by the Umatilla County Board of Commissioners that the amendments to the Umatilla County Development Ordinance as outlined in Attachments 1 and 2 be adopted. Furthermore, these amendments will take effect immediately as an emergency exists.

DATED THIS 15th day of April, 1987.

UMATILLA COUNTY BOARD OF COMMISSIONERS

Glenn Youngman, Chairman

Jeanne Hughes, Vice-Chairman

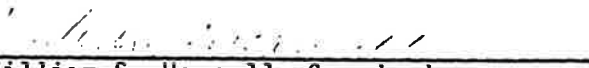
William S. Hansell, Commissioner

ATTESTED: J. Dean Fouquette, Sr.

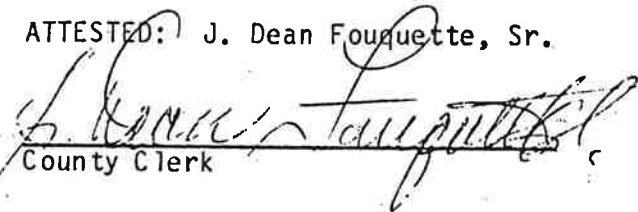
County Clerk

Attachment #1

(Page 192)

Section 10.210(5)(G)(2), amend as follows: "If a public road or recorded easement for access purposes in a Type II Land Division will serve four or more lots and will likely serve additional parcels due to development pressures in the area, or likely be an extension of a future road as specified in a future road plan, a minimum of a ~~\$0~~ 60 ft. right-of-way shall be required ~~and be in~~ for new roads and shall be improved to a ~~B~~ B-1 standard. Right-of-way widths for existing roads shall be determined by the Transportation/Master Road Plan when completed."

(Page 217)

Section 10.600(3)(a), amend as follows: "Unless otherwise stated in the Ordinance or the Transportation/Master Road Plan, dedicated rights-of-way for public use shall have a minimum width of ~~\$0~~ 60 feet and shall be improved to a D standard.

End of Ordinance

Delete existing road standards A-1, A-2, A-3, A-4, A-5, B-1, B-2, B-3, C and D and replace with Road Department standards D, B-1 and A-2.

Portions to be deleted are || while portions added are underlined.

TYPE OF AREA
FOR COUNTY ROAD STANDARDS

	RESIDENT/ AGRICULTURAL	INDUSTRIAL
Phase 1	"D" 12" crushed rock	"D" (modified) 18" crushed rock
Phase 2	"B-1" 6" crushed rock base 2" crushed rock level course 1/4" O-11 oil mat (min)	"B-1" (modified) 16" crushed rock base 2" crushed rock level course 4" asphaltic concrete
Phase 3	"A-2" 6" crushed rock base 2" crushed rock level course 2" asphaltic concrete	

UMATILLA COUNTY DEPARTMENT of PUBLIC WORKS

_____, Director of Public Works

Date: 11-30-86

Drawn By: MLD

60' r. of way

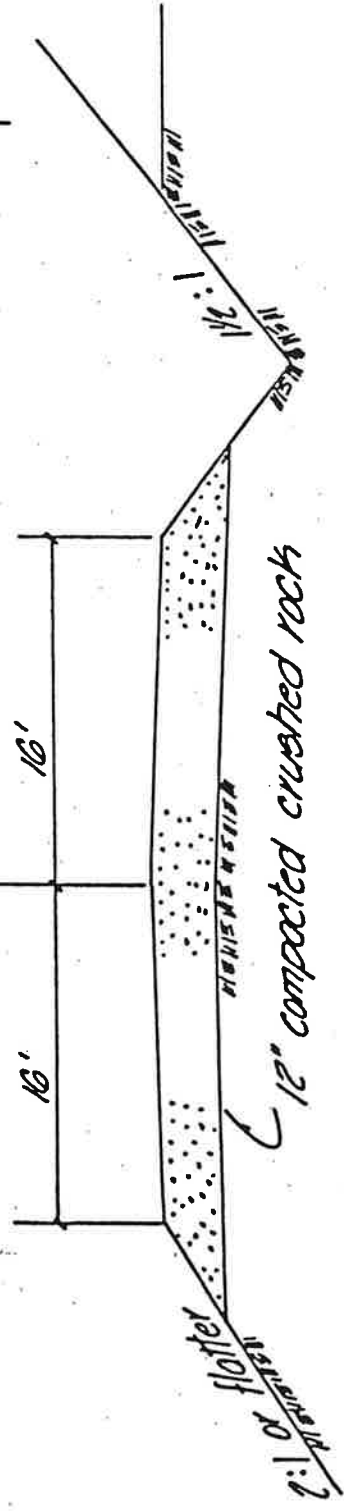

12" compacted crushed rock

"D" CROSS SECTION

60' right of way

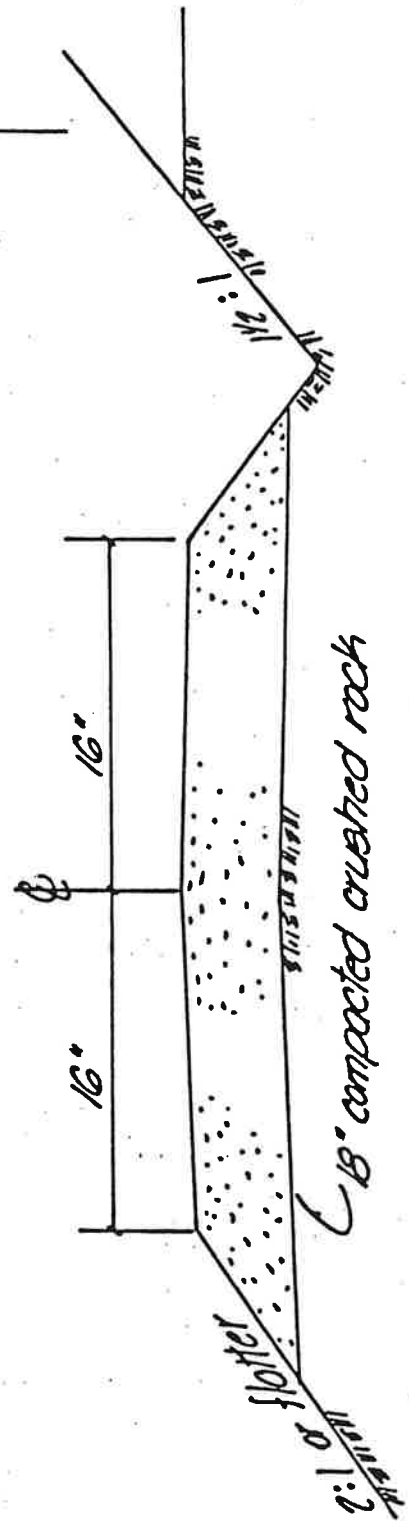

18" compacted crushed rock

"D" CROSS SECTION (modified)

Notes:

1. Construction outside R/W shall require slope easements.
2. Roadway shall be compacted to 95% maximum density.
3. Surface road will conform to Subdivision, Local Street Standard

Phase 1

Umatilla County Dept. of Public Works	
F-5	
Rural Standard	
Drawn By: MLD	
Date: 11-30-86	Food Standard
appd:	"D" & "D" (modified)

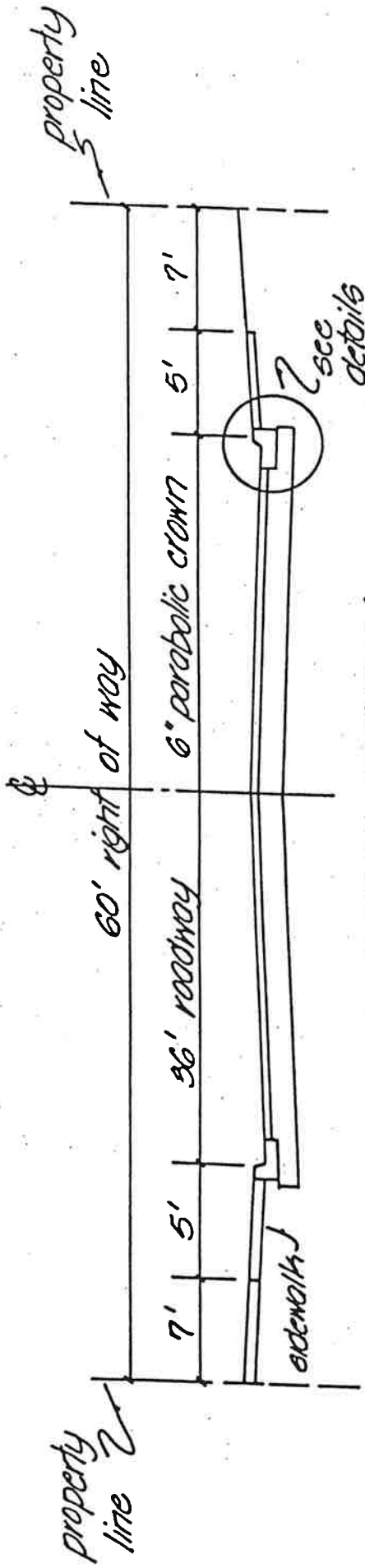

CROSS SECTION

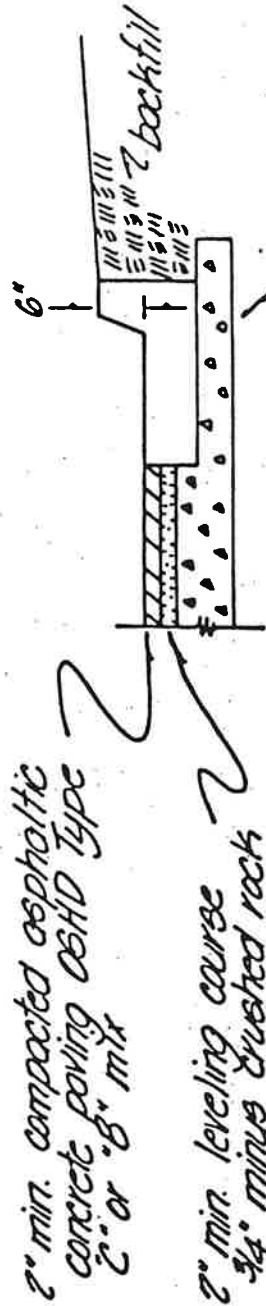

6" min. base course - 1 1/2" minus crushed rock compacted to 95% relative density or

10" river run compacted to 95% relative density

Alternate depth as determined by CBR or equal test

Phase 3

Umatilla County Dept. of Public Works

Urban Arterial Street

Drawn By: MLD

Date: 11-30-86

app'd:

Road Standard "A-2"

60' right-of-way

⊕

38' out to out subgrade

32' shoulder to shoulder

3' 4' 24' roadway 4' 3'

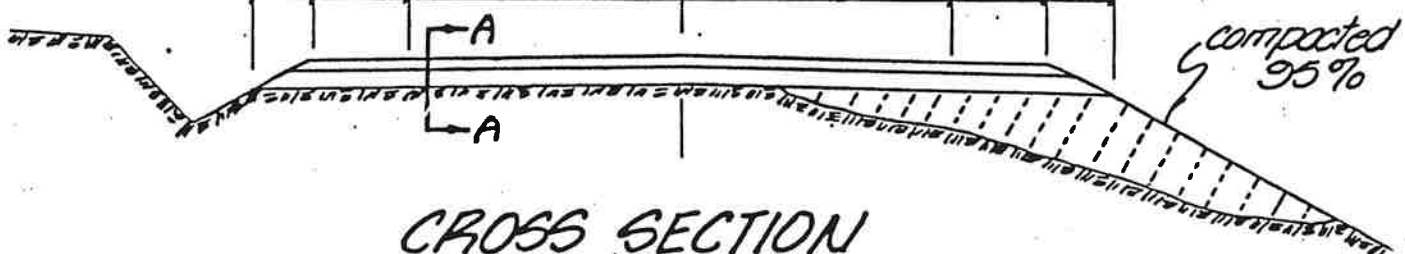

CROSS SECTION

nts

Asphaltic Concrete

4" compacted Class "B" or "C"
 1 1/4" (0-11) oil mat surface may
 be substituted for the
 asphaltic concrete

SECTION A-A

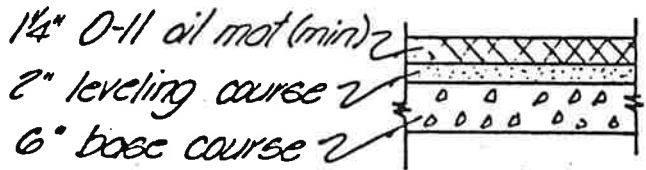

Leveling Course (3/4"-0)

2" min. when placed over
 1 1/2"-0 or ≤ 3" river run
 3" min. when placed over
 > 3" river run
 Rock compacted to 95%
 relative density

"B-1"

residential & agricultural

Base Course (1 1/2"-0)

6" min. (1 1/2"-0)
 12" min. river run or shale
 or
 16" min. river run for "B-1"
 modified
 Rock compacted to 95%
 relative density

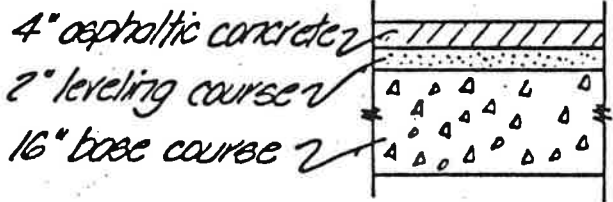

"B-1"
(modified)
industrial

Alternate depth as determined
by C.B.R. or equal test

Phase 2

Umatilla County Dept. of Public Works	
Suburban	
Arterial Street	
Drawn By: MLD	
Date: 11-30-86	Food Standard
opp'd:	B-1 & B-1 (modified)

LOT AND STREET DEFINITIONS

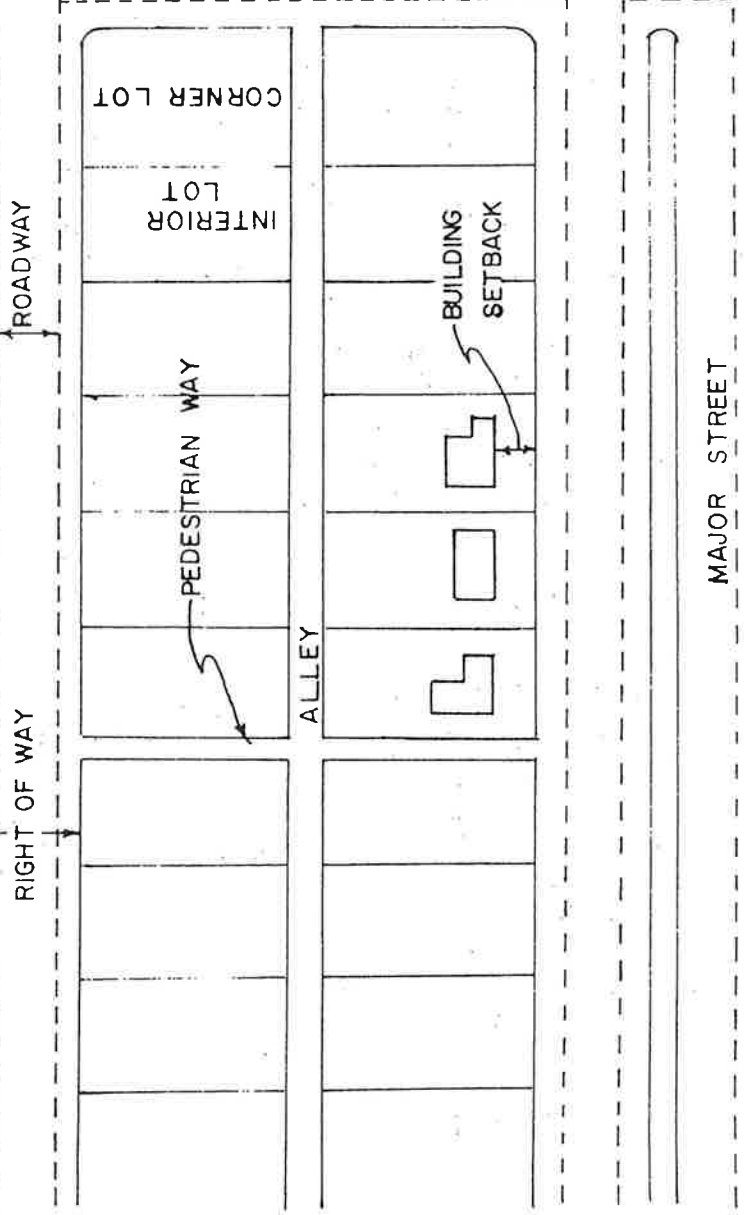
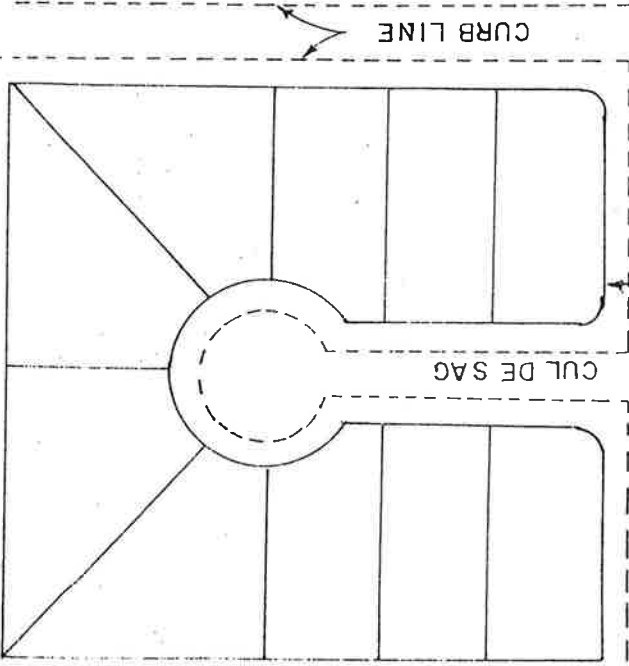
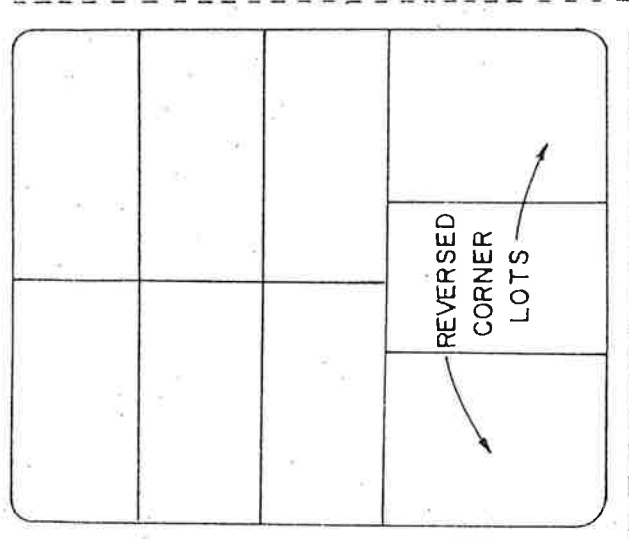
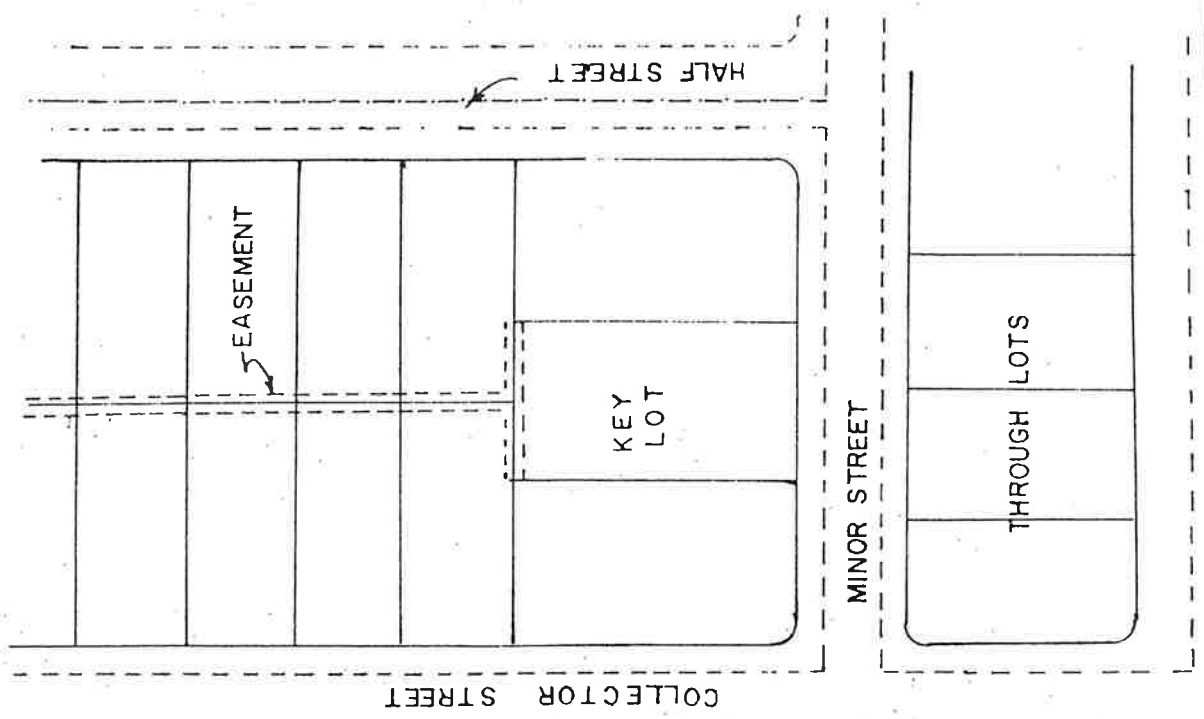

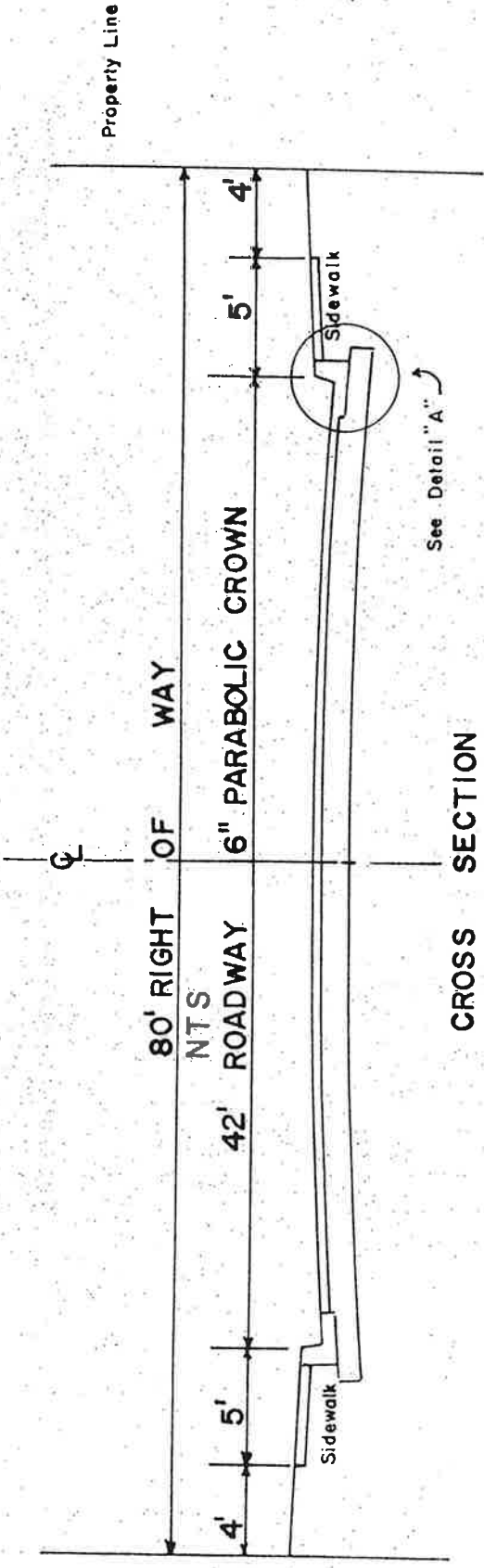

DETAIL "A"

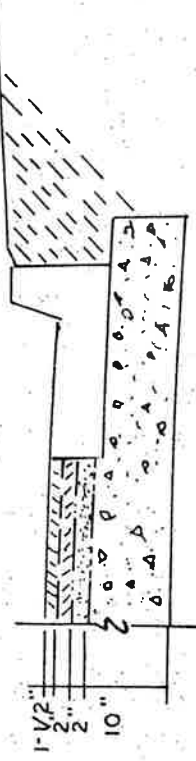

- 1-1/2" Min. Compacted Asphaltic Concrete Paving
 - 0.5% Min. S.H.D. Type "C" Mix.
 - 2" Min. Compacted Asphaltic Concrete Paving
 - 0.5% Min. S.H.D. Type "B" or "C" Mix.
 - 2" Min. Leveling Course — 3/4" Minus Crushed Rock Compacted To 95% Relative Density
 - 8" Min. Base Course — 1-1/2" Minus Crushed Rock Compacted To 95% Relative Density
- Alternate Depth As Determined By C.B.R. Or Equal Test

UMATILLA COUNTY ROAD OFFICE	
URBAN SERVICE AND INDUSTRIAL STREET	
DATE: 9-9-74	ROAD STANDARD
APP'D. _____	A-1

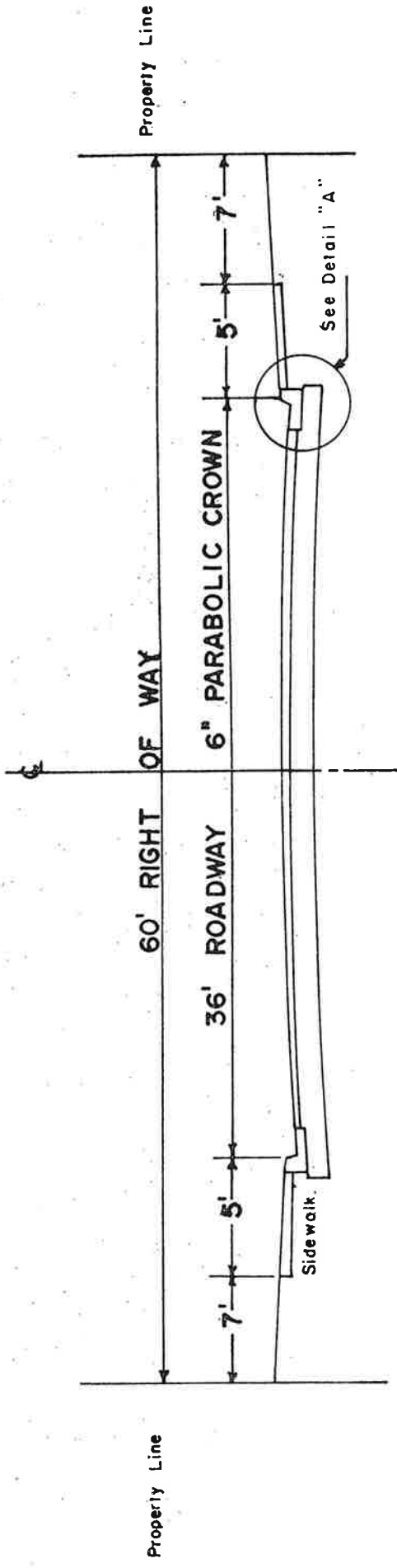

CROSS SECTION

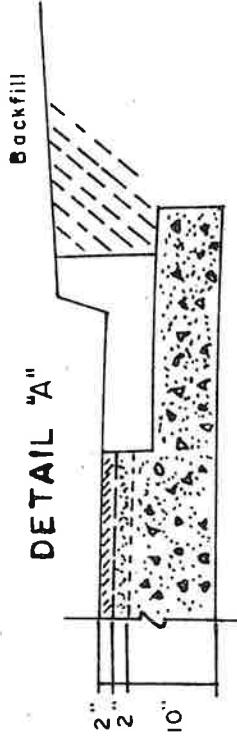

- 2" Min. Compacted Asphaltic Concrete Paving O.S.H.D. Type "C" or "B" Mix.
 - 2" Min. Leveling Course — 3/4" Minus Crushed Rock Compacted To 95% Relative Density.
 - 6" Min. Base Course — 1 1/2" Minus Crushed Rock Compacted To 95% Relative Density
- Alternate Depth As Determined By C.B.R. Or Equal Test

UMATILLA COUNTY ROAD OFFICE	
URBAN	
ARTERIAL STREET	
DATE: 9-3-74	ROAD STANDARD
APP'D.	A-2

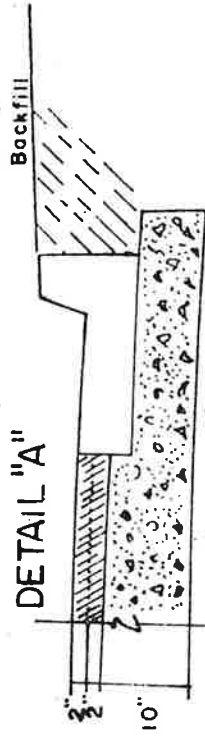
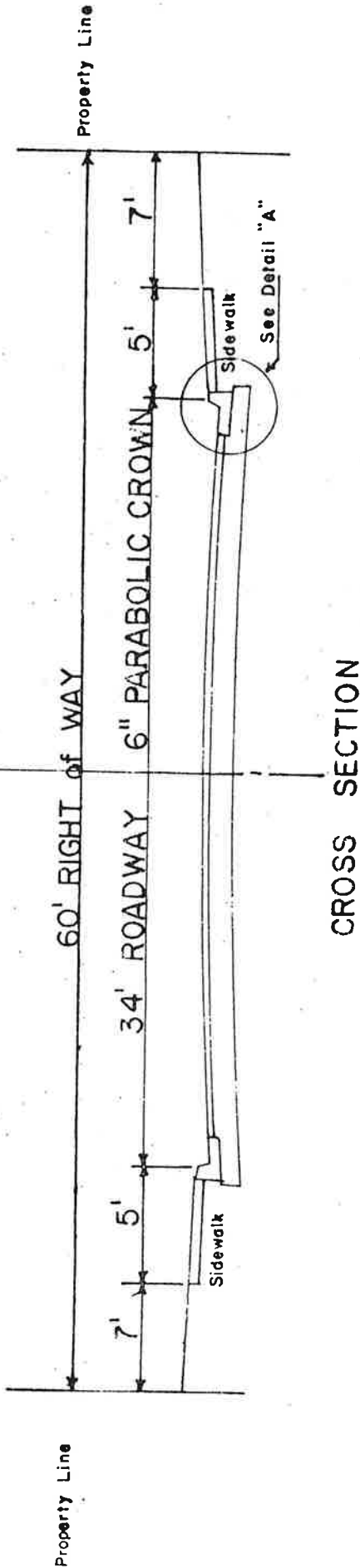

- 2" Min. Compacted Asphaltic Concrete Paving
O.S.H.D. Type "C" or "B" Mix.
- 2" Min. Leveling Course - 3/4" Minus Crushed
Rock Compacted To 95% Relative Density
- 6" Min. Base Course - 1 1/2" Minus Crushed Rock
Compacted To 95% Relative Density.

All alternate Depth as Determined By C.B.R. or Equal Test.

UMATILLA COUNTY ROAD OFFICE

URBAN
COLLECTOR STREET

ATE 9-4-74 ROAD STANDARD
PP'D. A-3

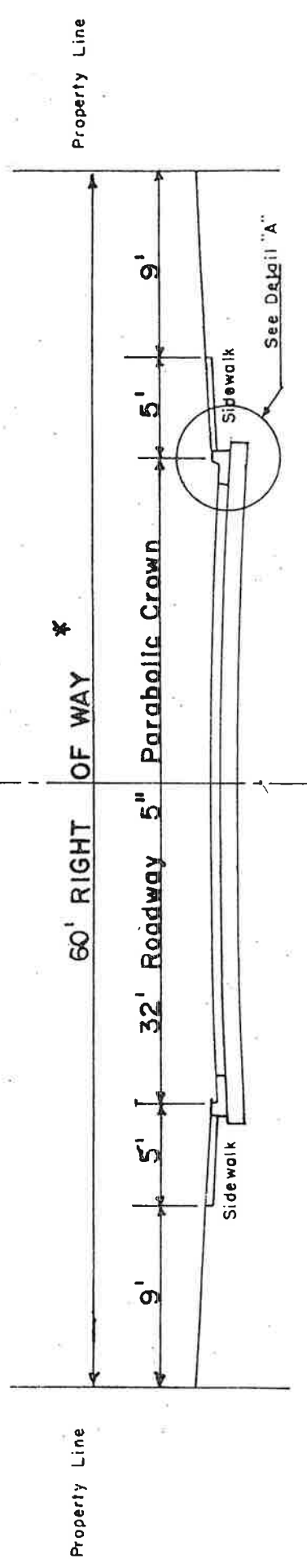

CROSS SECTION

* May be Reduced to 50' When Fully Improved with Max. Length of 600ft.

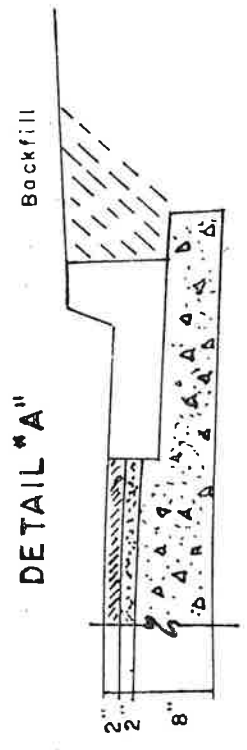

- 2" Min. Compacted Asphaltic Concrete Paving O.S.H.D. Type "C" or "B" Mix.
- 2" Min. Leveling Course — 3/4" Minus Crushed Rock Compacted To 95% Relative Density
- 6" Min. Base Course — 1 1/2" Minus Crushed Rock Compacted To 95% Relative Density
- Alternate Depth As Determined By C.B.R. or Equal Test

UMATILLA COUNTY ROAD OFFICE	
URBAN	
MINOR STREET	
DATE: 9-9-74	ROAD STANDARD
APP'D.	A-4

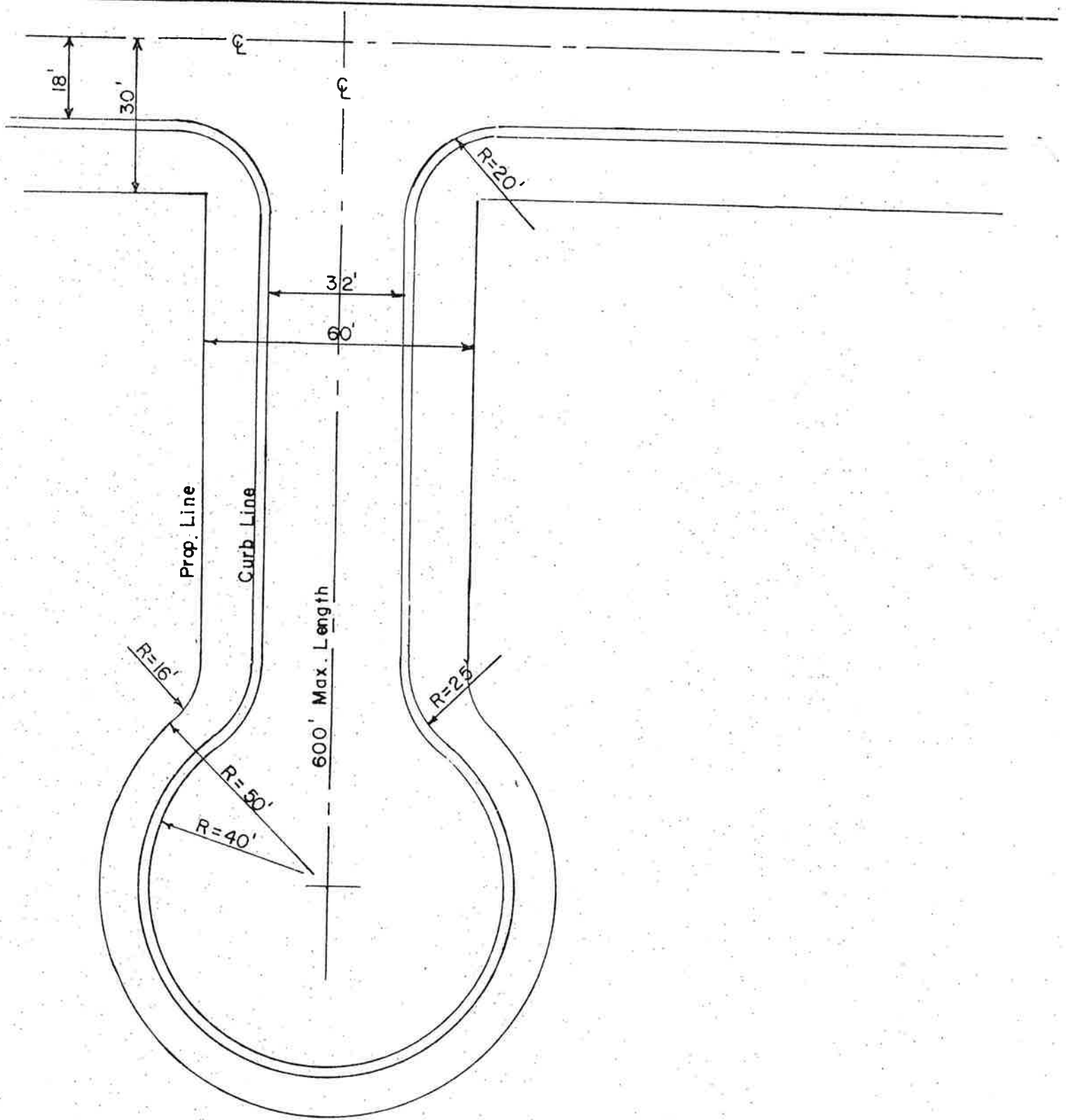

NOTE:
 FOR TYPICAL SECTION
 SEE URBAN COLLECTOR STREET

UMATILLA COUNTY ROAD OFFICE	
URBAN CUL-DE-SAC	
DATE 3-20-74	ROAD STANDARD
APP'D.	A-5

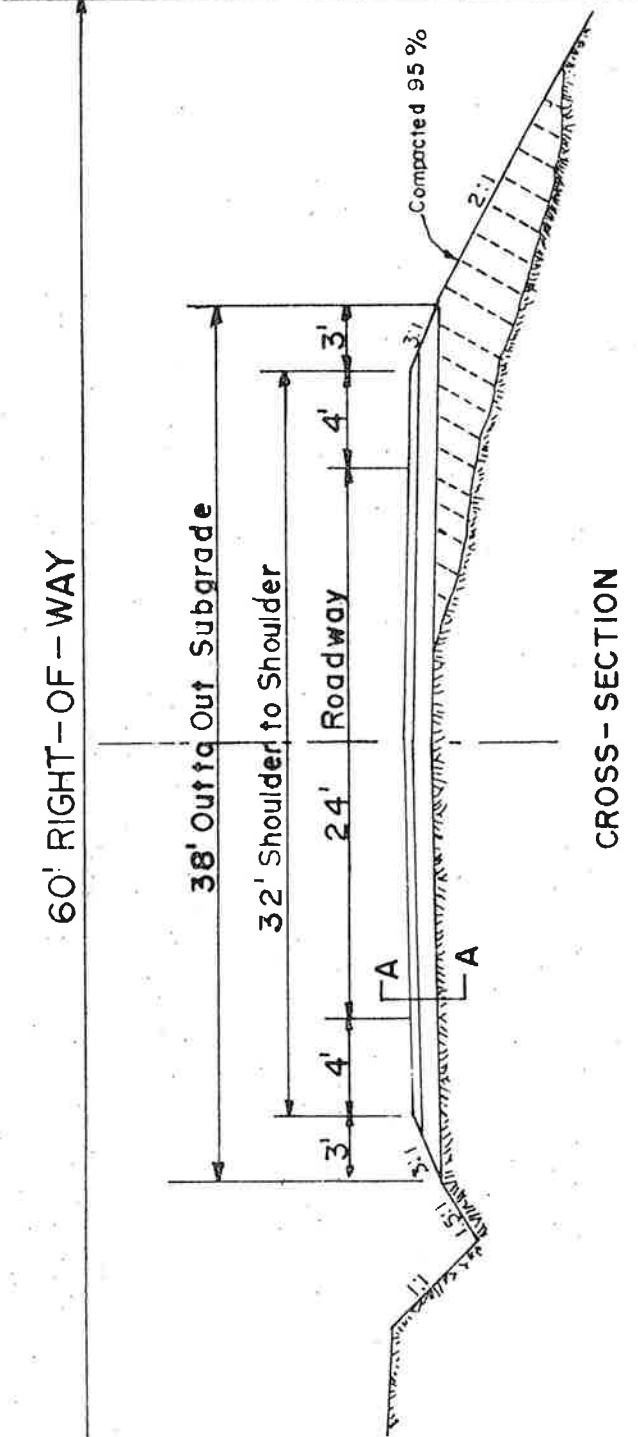

CROSS - SECTION

Asphaltic Concrete
 2" Compacted Class "B" or "C"
 1-1/4" (0-II Oil Mat surface may
 be substituted for the Asphaltic
 Concrete.

Leveling Course (3/4"-0)
 2" min. when placed over 1-1/2"-0 or
 river run \approx (3").

3" min when placed over river run \geq (3").
 Rock Compacted to 95% relative
 density.

Base Course (1/2"-0)

- 6" min base (1-1/2"-0) C.R.
 - 12" min. base River Run or Shale
 - Rock Compacted to 95% relative density
- Alternate Depth as determine by C.B.R.
 or equal Test.

SECTION A-A

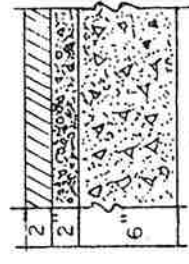

UMATILLA COUNTY ROAD OFFICE	
SUBURBAN	
ARTERIAL STREET	
DATE: 3-18-74	ROAD STANDARD
B-1	
APP'D	

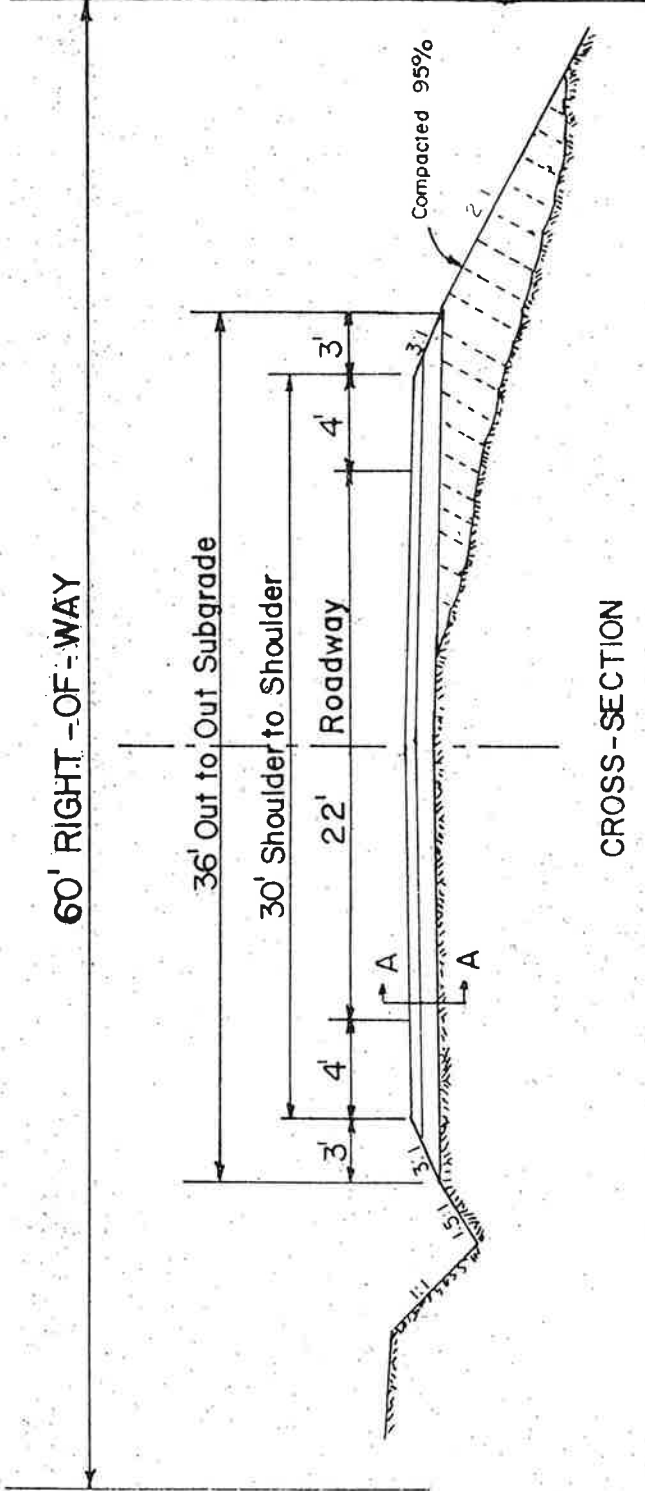

CROSS-SECTION

Asphaltic Concrete
 2" Compacted Class 'B' or 'C'
 1-1/4" (0-11) oil Mat surface may
 be substituted for the Asphaltic
 Concrete.

SECTION A-A

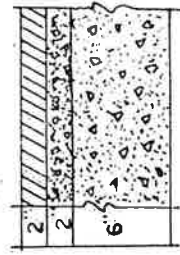

Leveling Course (3/4"-0)
 2" min when placed over 1-1/2"-0 or
 river run \leq (3")
 3" min when placed over river run (3")
 Rock Compacted to 95% relative
 density.

Base Course (1/2"-0)
 6" min base (1-1/2"-0) C. R.
 12" min base River Run or Shale.
 Rock Compacted to 95% relative density.
 Alternate Depth as determine by C.B.R.
 or equal Test

UMATILLA COUNTY ROAD OFFICE	
SUBURBAN	
COLLECTOR STREET	
DATE:	ROAD STANDARD
APP'D	B-2

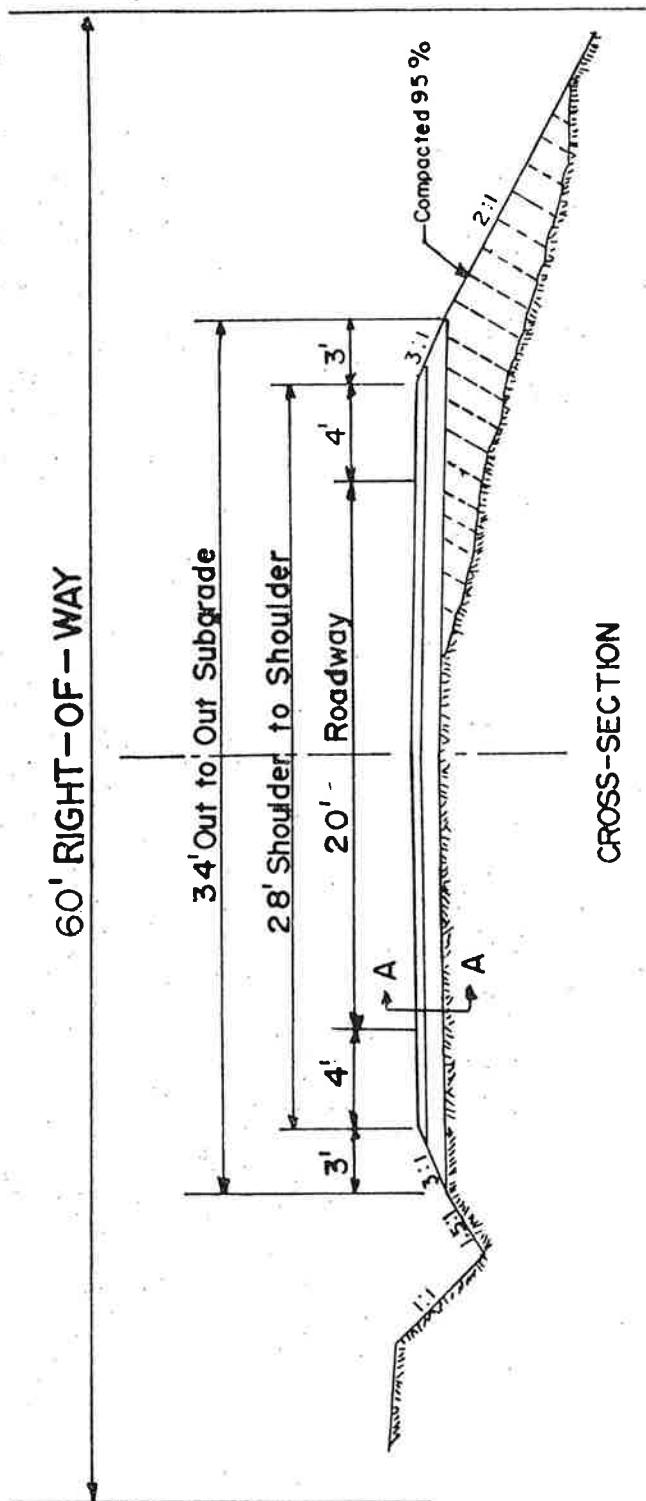

SECTION-A

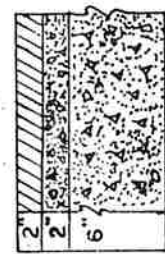

Asphaltic Concrete
 2" Compacted Class "B" or "C"
 1-1/4 (0-II) Oil Mat surface may
 be substituted for the Asphaltic
 Concrete

Leveling Course (3/4" - 0)
 2" min. when placed over 1-1/2" - 0 or
 river run \leq (3").
 3" min when placed over river run $>$ (3").
 Rock Compacted to 95% relative
 density.

Base Course (1-1/2" - 0)

6" min base (1-1/2" - 0) C.R.
 12" min. base River Run or Shale.
 Rock Compacted to 95% relative density
 Alternate Depth as determine by C.B.R.
 or equal Test.

UMATILLA COUNTY ROAD OFFICE	
SUBURBAN MINOR STREET	
DATE: 3-19-74	ROAD STANDARD
APP'D	B-3

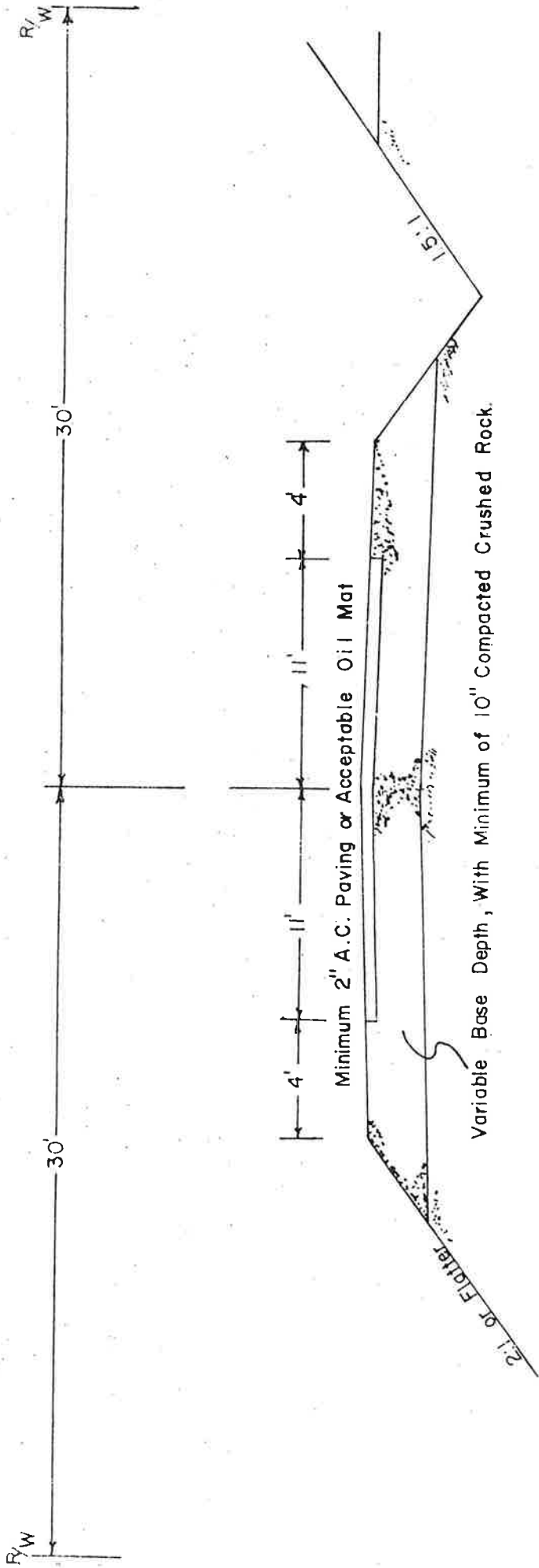

NOTES:

- (1) Construction out R/W line shall require slope easements.
- (2) Sub-base and base compacted to 95% of maximum density.
- (3) R/W cleared a minimum of 25 feet on both sides of center line.

UMATILLA COUNTY ROAD OFFICE

R-4
RURAL RECREATION
STANDARD

DATE 3-20-74 ROAD STANDARD
APP'D "C"